



# Table of Contents



<b>Company Profile</b> - bulletin 232-1-----	<b>01</b>
<b>Policies, Warranties and Agencies</b> - bulletin 232-2-----	<b>02</b>
<b>Features</b> - bulletin 233-----	<b>03</b>
<b>56 frame</b>	
<b>56 1/3-3 hp aluminum frame</b> - bulletin 252-----	<b>04</b>
<b>56C frame 1/3-3hp aluminum frame</b> - bulletin 253-----	<b>05</b>
<b>NEMA Cast Iron TEFC</b>	
<b>Premium Efficient T frame 1-250 hp</b> - bulletin 227-----	<b>06-07</b>
<b>Premium Efficient TC frame 1-200 hp</b> - bulletin 228-----	<b>08-09</b>
<b>Design C EAct Efficient T frame 1-200 hp</b> - bulletin 200-----	<b>10-11</b>
<b>Design C EAct Efficient TC frame 1-200 hp</b> - bulletin 220-----	<b>12-13</b>
<b>Crusher Duty 1-500 hp</b> - bulletin 223-----	<b>14</b>
<b>JM Pump EAct Efficient 1-100 hp</b> - bulletin 240-----	<b>15-16</b>
<b>JM Pump Premium Efficient 1-100 hp</b> - bulletin 241-----	<b>17-18</b>
<b>Design D Oil Well Pump 3-150 hp</b> - bulletin 224-----	<b>19</b>
<b>Stainless Steel TEFC</b>	
<b>C face 1/4-2 hp</b> - bulletin 222-----	<b>20</b>
<b>C face no feet 1/4-30 hp</b> - bulletin 243-----	<b>21-22</b>
<b>JM Pump 1-30 hp</b> - bulletin 255-----	<b>23</b>
<b>Premium Efficient 1-30 hp</b> - bulletin 242-----	<b>24</b>
<b>Premium Efficient JM Pump 1-30 hp</b> - bulletin 254-----	<b>25</b>
<b>Metric TEFC</b>	
<b>IE1 B35 &amp; B34 aluminum frame 0.18-1.1kW</b> - bulletin 245-----	<b>26</b>
<b>IE3 B3 aluminum frame 0.75-18.5kW</b> - bulletin 210-----	<b>27</b>
<b>IE3 B35 aluminum frame 0.75-18.5kW</b> - bulletin 212-----	<b>28</b>
<b>IE3 B3 cast iron frame 20-90kW</b> - bulletin 213-----	<b>29</b>
<b>IE3 B35 cast iron frame 20-90kW</b> - bulletin 215-----	<b>30</b>
<b>IE3 B5 cast iron frame no feet 20-90kW</b> - bulletin 214-----	<b>31</b>
<b>Dimensional Data</b>	
<b>T &amp; TC frame</b> - bulletin 231-----	<b>32</b>
<b>JM Pump</b> - bulletin 256-----	<b>33</b>
<b>Stainless Steel</b> - bulletin 238-----	<b>34</b>
<b>Metric</b> - bulletin 216-----	<b>35</b>
<b>Test Data</b>	
<b>T &amp; TC Premium Efficiency</b> - bulletin 235-----	<b>36</b>
<b>Design D Oil Well Pump</b> - bulletin 230-----	<b>37</b>
<b>Stainless Steel</b> - bulletin 237-----	<b>38</b>
<b>Metric IE1 50/60 Hertz</b> - bulletin 250-----	<b>39</b>
<b>Metric IE3 50/60 Hertz</b> - bulletin 257-----	<b>40</b>
<b>Accessories</b> - bulletin 244-----	<b>41-42</b>



**Reliable Electric Motor Company, Inc.** is dedicated to utilizing select Master Distributors enabling them to be more competitive in the replacement market and to penetrate OEM potentials that have been out of reach due to price. These Master Distributors benefit from our “direct from the source” pricing, high quality products with a broad range of ratings in NEMA, metric, above NEMA, medium voltage, and DC models in a variety of construction and features to satisfy customer requirements. End customers benefit by purchasing dependable motors at affordable prices. To this end, for the last ten years, we have partnered with Anhui Wannan Motor Co., LTD in China. The motor brand is “Reliable Electric”.

**Anhui Wannan Motor Co., LTD** (commonly referred to as Wannan Motor or WNM) is a private enterprise with nearly sixty years experience in the manufacture of motors and currently builds a wide range of motor types of very high quality sold in Asian, European, Australia and now North American markets.

The quality of these motors is obvious from examining the external appearance or a teardown inspection. Even one horsepower motors receive VPI winding treatment process. The quality is backed by an exceptionally low failure rate. Customers in the U.S. have testified to the high quality of these motors serving the most demanding applications. Total manufacturing facilities exceed 2 million sq. ft., much of which is located on a new 125 acre site close to their original half million sq. ft. manufacturing and office facilities.

Anhui Wannan Motor Co., LTD is a 2006 winner of “China Top Brand” award. This is the highest honor for products manufactured in China. Wannan Motors is the only motor company to ever receive this honor. Only seven other manufacturers received this award in 2006 during ceremonies at the People’s Congress Hall in Beijing.

Wannan Motor builds medium and high voltage designs offered in a wide range of construction and protection in ratings and features exceeding 5000 hp depending on configurations and application. Quotations for specialty ratings are available to all Reliable Electric distributors on an individual specification basis. Let know your customer’s specifications.



Reliable Electric Motor Company, Inc. markets high quality, high value motors sold through Master Distributors who have signed a contract outlining an agreed upon protected geography and other general terms of sale. But, the most desirable policy under which we operate our business is of mutual trust that both parties will maintain the intent of the written agreement.

Warranty - Reliable Electric motors (catalog ratings to 600 hp) are protected by our limited 3 year warranty (1 year in operation or 3 years from manufactured date code). Above NEMA motors are protected by a limited 2 year warranty (1 year in operation or 2 years from manufactured date code). The date code is listed in the serial number block on each motor nameplate.

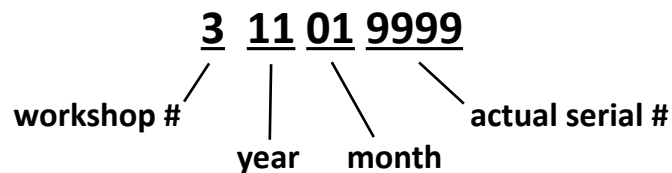

Warranties are inspected, serviced or warranted by any EASA (Electrical Apparatus Service Association) Shop in good standing. It is the responsibility of the customer to arrange transportation to and from the warranty shop, including transportation from the actual job site. The warranty shop must contact REMC with an estimate of repair cost (with a properly completed EASA 1097 Repair Report) for approval of repair or replacement authorization.

Agency approvals - Reliable Electric brand motors manufactured by Wannan Motors are listed with agencies around the world. For North American markets the motors have been evaluated and recognized by:

**ISO9001**  
Cert # 3400/97879

**CC068A**  
Cert # 1614452



**SP**  
C US  
File # 216983

**UL**  
C US  
File # E313690

**Motors are also RoHS Compliant**



**All General Purpose ratings meet US efficiency mandate of December 19, 2010**

**Premium TEFC (IP54) cast iron frame and brackets with high quality appearance - two drain holes - solid full frame mounting feet**

**All motors are VPI impregnated copper windings - class F insulation - class B temperature rise**

**All motors are suitable for inverter use - check specific product literature for operating ranges**

**Stainless Steel ratings include 300 series parts & 4 condensate drains**

**Mounting feet are double punched - larger frames have holes for next smaller frame - example, (326) has holes for next smaller frame (324) - the 587 frame has holes for 449, 5008 & 5009 - 588 frame has holes for 449, 5008, 5010 & 5011**

**All cast iron conduit box with rubber gasket - ground lug inside box (stainless models have stamped stainless steel box) - rotatable in 90 degree increments**

**All T & TC motors are F1 - F2 convertible**

**NEMA frame models have standard U.S. bolts and screws**

**Stainless steel nameplate**

**Steel fan cover has special rust preventative treatment - cast iron available 400 -588 frame**

**Motors have shielded bearings 56 - 215 frame - 254 through 588 has re-greaseable bearings**

**50/60 rated - generally 190/380 @ 50 hz - 230/460 @ 60 hz operation**

**Quick change C-face and D-flange kits**

**Connections - 5 hp & smaller are dual voltage wye connected with nine leads - 7.5 hp & larger have twelve leads that can be connected for wye/delta or PWS (see nameplate for diagram)**

**We offer a wide variety of specialty motors in low, medium or high voltage - speed ranges that include 2 pole - 12 pole designs - construction in aluminum (smaller hp), cast iron, fabricated steel - a wide range of protective devices for temperature monitoring, space heaters, bearing current insulation - copper bar rotor designs and more.**

# 56 Frame 3 phase motors



TEFC - aluminum frame, brackets & conduit box - removable mounting base

**Features:** 60/50 hertz, 1.15 service factor, class F insulation, class B temperature rise, lip seals, VPI impregnated windings, F1, F2 or F3 conduit box position by moving mounting base location.

bulletin - #252

**1/3 - 3 hp**

**Applications Include:** pumps, fans, blowers, HVAC equipment, machine tools, compressors and other applications where duty cycle requires continuous operation.

Suitable for inverter use @ 10:1 variable torque or 5:1 constant torque.

Apply anywhere high quality - reliable performance is required.

HP	RPM	Frame	Catalog #	List Price	Shaft Dia.	Voltage	Rated Eff %	FL Amps	"C" Dim	Ship Wt.
1/3	3600	56	L0.332963	\$200	0.625	208-230 460 (FLA@460v)	72.0	0.55	12.60	25
	1800	56	L0.334975	\$193			72.0	0.66	12.60	23
	1200	56	L0.336983	\$234			66.0	0.78	12.60	27
	900	56	L0.338990	\$275			66.0	0.97	12.60	28
1/2	3600	56	L0.52964	\$208	0.625		74.0	0.78	12.60	26
	1800	56	L0.54976	\$195			74.0	0.94	12.60	24
	1200	56	L0.56984	\$244			68.0	1.13	12.60	28
	900	56H	L0.58991	\$281			68.0	1.36	13.60	29
3/4	3600	56	L0.752965	\$215	0.625		75.5	1.16	12.60	27
	1800	56	L0.754977	\$208			75.5	1.36	12.60	25
	1200	56H	L0.756985	\$275			70.0	1.39	13.60	29
	900	56H	L0.758992	\$315			70.0	1.90	13.60	31
1	3600	56H	L012966	\$227	0.625	208-230 460 (FLA@460v)	77.0	1.43	13.60	28
	3600	56HZ	L0121002	\$227	0.875		77.0	1.43		28
	1800	56H	L014978	\$243	0.625		77.0	1.71		31
	1800	56HZ	L0141003	\$243	0.875		77.0	1.71		31
	1200	56H	L016986	\$316	0.625		72.5	2.07		34
	1200	56HZ	L0161006	\$316	0.875		72.5	2.07		34
	900	56H	L018993	\$338	0.625		72.0	2.33		36
	900	56HZ	L0181007	\$338	0.875		72.0	2.33		36
1 1/2	3600	56H	L1.52967	\$252	0.625	208-230 460 (FLA@460v)	78.5	2.14	13.60	36
	3600	56HZ	L1.52995	\$252	0.875		78.5	2.14		36
	1800	56H	L1.54979	\$288	0.625		78.5	2.47		32
	1800	56HZ	L1.54998	\$288	0.875		78.5	2.47		32
	1200	56H	L1.56988	\$341	0.625		72.5	2.60		38
	1200	56HZ	L1.561001	\$341	0.875		72.5	2.60		38
2	3600	56H	L022969	\$267	0.625	208-230 460 (FLA@460v)	80.0	2.71	13.60	43
	3600	56HZ	L022996	\$267	0.875		80.0	2.71		43
	1800	56H	L024981	\$326	0.625		81.5	2.90		36
	1800	56HZ	L024999	\$326	0.875		81.5	2.90		36
3	3600	56H	L032971	\$322	0.625	208-230 460 (FLA@460v)	81.0	4.00	13.60	47
	3600	56HZ	L032997	\$322	0.875		81.0	4.00		47



CC068A

ISO9001

RoHS Compliant

detachable base has 8 holes 56, 56H, 143T or 145T mounting

# 56 Frame C-face & J shaft 3 phase motors



TEFC - aluminum frame, brackets & conduit box - removable mounting base

**Features:** 60/50 hertz, 1.15 service factor, class F insulation, class B temperature rise, lip seals, VPI impregnated windings, F1, F2 or F3 conduit box position by moving mounting base location.

bulletin - #253

**1/3 - 3 hp**

**Applications Include:** pumps, fans, blowers, HVAC equipment, machine tools, compressors and other C-face applications where duty cycle requires continuous operation.

Suitable for inverter use @ 10:1 variable torque or 5:1 constant torque.

Apply anywhere high quality - reliable performance is required.

HP	RPM	Frame	Catalog #	List Price	Shaft Dia.	Voltage	Rated Eff %	FL Amps	"C" Dim	Ship Wt.		
1/3	3600	56C	LC0.332517	\$206	0.625	208-230 460  (FLA@460v)	72.0	0.55	12.60	26		
	1800	56C	LC0.334523	\$199			72.0	0.66	12.60	24		
1/2	3600	56C	LC0.52518	\$215	0.625		74.0	0.78	12.60	27		
	1800	56C	LC0.54524	\$201			74.0	0.94	12.60	25		
3/4	3600	56C	LC0.752519	\$222	0.625		75.5	1.16	12.60	28		
	1800	56C	LC0.754525	\$214			75.5	1.36	12.60	26		
1	3600	56HC	LC012520	\$234	0.625		(FLA@460v)	77.0	1.43	13.60	29	
	3600	56HCZ	LC0121005	\$234	0.875			77.0	1.43		29	
	1800	56HC	LC014526	\$250	0.625			77.0	1.71		32	
	1800	56HCZ	LC0141005	\$250	0.875			77.0	1.71		32	
1 1/2	3600	56HC	LC1.52521	\$259	0.625			78.5	2.14		13.60	37
	3600	56HCZ	LC1.52968	\$259	0.875			78.5	2.14			37
	1800	56HC	LC1.54527	\$297	0.625	78.5		2.47	33			
	1800	56HCZ	LC1.54980	\$297	0.875	78.5		2.47	33			
2	3600	56HC	LC022522	\$275	0.625	80.0		2.71	13.60		44	
	3600	56HCZ	LC022970	\$275	0.875	80.0		2.71			44	
	1800	56HC	LC024528	\$335	0.625	81.5		2.90			37	
	1800	56HCZ	LC024982	\$335	0.875	81.5		2.90			37	
3	3600	56HC	LC032972	\$331	0.625	81.0	4.00	13.60	48			
	3600	56HCZ	LC032974	\$331	0.875	81.0	4.00		48			
<b>56J threaded shaft - 303 stainless steel</b>												
1/3	3600	56J	LJ0.332577	\$231	0.625	208-230 460  (FLA@460v)	72.0	0.55	12.60	26		
	1800	56J	LJ0.334583	\$218			72.0	0.66	12.60	24		
1/2	3600	56J	LJ0.52578	\$240	0.625		74.0	0.78	12.60	27		
	1800	56J	LJ0.54584	\$220			74.0	0.94	12.60	25		
3/4	3600	56J	LJ0.752579	\$247	0.625		75.5	1.16	12.60	28		
	1800	56J	LJ0.754585	\$233			75.5	1.36	12.60	26		
1	3600	56HJ	LJ012574	\$259	0.625		(FLA@460v)	77.0	1.43	13.60	29	
	1800	56HJ	LJ014580	\$275	0.625			77.0	1.71		32	
1 1/2	3600	56HJ	LJ1.52575	\$285	0.625			77.8	2.14		13.60	37
	1800	56HJ	LJ1.54581	\$322	0.625			78.5	2.47			33
2	3600	56HJ	LJ022576	\$300	0.625			80.0	2.71		13.60	44
	1800	56HJ	LJ024582	\$360	0.625			81.5	2.90			37
3	3600	56HJ	LJ032973	\$356	0.625	81.0		4.00	13.60		48	



CC068A

ISO9001

RoHS Compliant

removable base has 8 holes 56, 56H, 143T or 145T mounting

# Premium Efficient 3 phase motors



TEFC - rigid base - cast iron frame, brackets & conduit box

**Features:** 60/50 hertz, 1.15 service factor, class F insulation, class B temperature rise, NEMA design B starting, lip seals, epoxy paint, VPI impregnated windings, full length mounting feet.

bulletin - #227

## 1 - 250 hp

**Applications Include:** pumps, fans, blowers, saw mills, HVAC equipment, machine tools, compressors and other applications where duty cycle requires continuous operation.



Suitable for inverter use @ 20:1 variable torque or 10:1 constant torque.

Apply anywhere high quality - reliable performance is required.

HP	RPM	Frame	Catalog #	List Price	DE Bearing	Voltage	Rated Eff %	FL Amps	"C" Dim	Ship Wt.
1	3600	143T	AP012677	\$362	6205	208-230 460	77.0	1.50	13.5	61
	1800	143T	AP014698	\$362	6205		85.5	1.43	13.5	64
	1200	145T	AP016721	\$428	6205		82.5	1.60	14.5	78
1.5	3600	143T	AP1.52678	\$382	6205	208-230 460	84.0	1.88	13.5	63
	1800	145T	AP1.54699	\$402	6205		86.5	2.08	14.5	71
	1200	182T	AP1.56718	\$568	6206		87.5	2.12	16.2	101
2	3600	145T	AP022679	\$423	6205	208-230 460	85.5	2.4	14.5	74
	1800	145T	AP024700	\$432	6205		86.5	2.7	14.5	77
	1200	184T	AP026719	\$629	6306		88.5	2.8	17.1	109
3	3600	182T	AP032680	\$588	6306	208-230 460	86.5	3.6	16.2	104
	1800	182T	AP034701	\$559	6306		89.5	3.7	16.2	109
	1200	213T	AP036720	\$891	6208		89.5	4.0	18.0	166
5	3600	184T	AP052681	\$663	6306	208-230 460	88.5	5.9	17.1	114
	1800	184T	AP054702	\$657	6306		89.5	6.1	17.1	123
	1200	215T	AP056697	\$1,058	6208		89.5	6.4	20.0	178
7.5	3600	213T	AP7.52682	\$960	6208	208-230 460	89.5	8.6	18.0	178
	1800	213T	AP7.54703	\$949	6208		91.7	8.9	18.0	194
	1200	254T	AP7.56722	\$1,466	6309		91.0	9.7	23.5	288
10	3600	215T	AP102683	\$1,087	6208	208-230 460	90.2	11.2	20.0	201
	1800	215T	AP104704	\$1,099	6208		91.7	11.8	20.0	221
	1200	256T	AP106723	\$1,739	6309		91.0	12.9	25.2	325
15	3600	254T	AP152684	\$1,795	6309	208-230 460	91.0	16.6	23.5	201
	1800	254T	AP154705	\$1,599	6309		92.4	17.1	23.5	221
	1200	284T	AP156724	\$2,245	6311		91.7	18.4	26.6	325
20	3600	256T	AP202685	\$1,967	6309	208-230 460	91.0	22.1	23.5	339
	1800	256T	AP204706	\$1,904	6309		93.0	22.6	23.5	382
	1200	286T	AP206725	\$2,602	6311		91.7	24.4	26.6	516
25	3600	284TS	AP252686	\$2,170	6311	208-230 460	91.7	27.4	25.2	477
	1800	284T	AP254707	\$2,341	6311		93.6	28.0	26.6	505
	1200	324T	AP256726	\$3,328	6312		93.0	39.9	31.7	635
30	3600	286TS	AP302687	\$2,571	6311	208-230 460	91.7	32.9	26.7	507
	1800	286T	AP304708	\$2,660	6311		93.6	33.4	28.1	545
	1200	326T	AP306727	\$3,562	6312		93.0	36.0	33.3	654
40	3600	324TS	AP402688	\$3,449	6312	230 460	92.4	44.3	30.2	627
	1800	324T	AP404709	\$3,404	6312		94.1	45.2	31.7	680
	1200	364T	AP406728	\$4,282	6314		94.1	46.4	33.7	905
50	3600	326TS	AP502698	\$3,862	6312	230 460	93.0	54.8	31.5	738
	1800	326T	AP504710	\$4,053	6312		94.5	55.9	33.3	787
	1200	365T	AP506729	\$5,365	6314		94.1	57.8	37.1	994



CC068A

ISO9001

RoHS Compliant

Suitable for horizontal or vertical mounting



# Premium Efficient 3 phase motors



TEFC - rigid base - cast iron frame, brackets & conduit box

**Features:** 60/50 hertz, 1.15 service factor, class F insulation, class B temperature rise, NEMA design B starting, lip seals, epoxy paint, VPI impregnated windings, full length mounting feet.

bulletin - #227

## 1 - 250 hp

**Applications Include:** pumps, fans, blowers, saw mills, HVAC equipment, machine tools, compressors and other applications where duty cycle requires continuous operation.



Suitable for inverter use @ 20:1 variable torque or 10:1 constant torque.

Apply anywhere high quality - reliable performance is required.

HP	RPM	Frame	Catalog #	List Price	DE Bearing	Voltage	Rated Eff %	FL Amps	"C" Dim	Ship Wt.
60	3600	364TS	AP602690	\$5,005	6214	208-230 460	93.6	64.3	31.50	913
	1800	364T	AP604711	\$4,908	6214		95.0	67.0	33.70	968
	1200	404T	AP606730	\$6,627	6216		94.5	68.4	38.00	1172
75	3600	365TS	AP752691	\$5,622	6214	208-230 460	93.6	80.4	34.75	1050
	1800	365T	AP754712	\$5,054	6214		95.4	83.2	37.10	1051
	1200	405T	AP756731	\$7,187	6216		94.5	85.1	38.00	1344
100	3600	405TS	AP1002692	\$7,165	6216	208-230 460	94.1	107	35.00	1273
	1800	405T	AP1004713	\$7,314	6216		95.4	112	38.00	1296
	1800	405T	AP1004784	\$7,416	NU316		95.4	112	38.00	1296
	1200	444T	AP1006732	\$11,140	6318		95.0	115	45.10	1673
	1200	444T	AP1006789	\$11,296	NU318		95.0	115	45.10	1673
125	3600	444TS	AP1252693	\$10,876	6318	460	95.0	136	41.40	1666
	1800	445T	AP1254714	\$10,672	6318		95.4	136	45.10	1648
	1800	445T	AP1254785	\$10,822	NU318		95.4	136	45.10	1648
	1200	447T	AP1256733	\$12,314	6218		95.0	142	45.10	1826
	1200	445T	AP1256790	\$12,487	NU318		95.0	142	45.10	1826
150	3600	445TS	AP1502694	\$12,976	6318	460	95.0	163	41.40	1711
	1800	445T	AP1504715	\$12,766	6318		95.8	162	45.10	1973
	1800	445T	AP1504786	\$12,945	NU318		95.8	162	45.10	1973
	1200	447T	AP1506734	\$14,846	6320		95.8	169	53.60	2343
	1200	447T	AP1506791	\$15,053	NU320		95.8	169	53.60	2343
200	3600	447TS	AP2002695	\$15,942	6320	460	95.4	214	50.00	2310
	1800	447T	AP2004716	\$16,713	6320		96.2	215	53.60	2193
	1800	447T	AP2004787	\$16,950	NU320		96.2	215	53.60	2193
	1200	449T	AP2006735	\$18,562	6320		95.8	224	54.75	2607
	1200	449T	AP2006792	\$18,823	NU320		95.8	224	54.75	2607
250	3600	449TS	AP2502696	\$18,688	6320	460	95.8	266	50.00	2443
	1800	449T	AP2504717	\$18,822	6320		96.2	267	54.75	2477
	1800	449T	AP2504788	\$19,089	NU320		96.2	267	54.75	2477



CC068A

ISO9001

RoHS Compliant

Suitable for horizontal or vertical mounting

# Premium Efficient C-face 3 phase motors



TEFC - rigid base - cast iron frame, brackets & conduit box

**Features:** 60/50 hertz, 1.15 service factor, class F insulation, class B temperature rise, NEMA design B starting, lip seals, epoxy paint, VPI impregnated windings, full length mounting feet.

bulletin - #228

## 1 - 250 hp

**Applications Include:** pumps, fans, blowers, saw mills, HVAC equipment, machine tools, conveyors and other C-face applications where duty cycle requires continuous operation.



Suitable for inverter use @ 20:1 variable torque or 10:1 constant torque.

Apply anywhere high quality - reliable performance is required.

HP	RPM	Frame	Catalog #	List Price	DE Bearing	Voltage	Rated Eff %	FL Amps	"C" Dim	Ship Wt.
1	3600	143TC	CP012736	\$374	6205	208-230 460	77.0	1.50	13.50	64
	1800	143TC	CP014752	\$381	6205		85.5	1.43	13.50	68
	1200	145TC	CP016768	\$442	6205		82.5	1.60	14.50	82
1.5	3600	143TC	CP1.52737	\$394	6205	208-230 460	84.0	1.88	13.50	67
	1800	145TC	CP1.54753	\$415	6205		86.5	2.08	14.50	75
	1200	182TC	CP1.56769	\$586	6306		87.5	2.12	16.20	106
2	3600	145TC	CP022738	\$436	6205	208-230 460	85.5	2.40	14.50	77
	1800	145TC	CP024754	\$445	6205		86.5	2.70	14.50	80
	1200	184TC	CP026770	\$649	6306		88.5	2.80	17.10	114
3	3600	182TC	CP032739	\$606	6306	208-230 460	86.5	3.60	16.20	108
	1800	182TC	CP034755	\$576	6306		89.5	3.70	16.20	114
	1200	213TC	CP036771	\$920	6208		89.5	4.00	18.00	175
5	3600	184TC	CP052740	\$683	6306	208-230 460	88.5	5.90	17.10	118
	1800	184TC	CP054756	\$678	6306		89.5	6.10	17.10	128
	1200	215TC	CP056772	\$1,092	6208		89.5	6.40	20.00	187
7.5	3600	213TC	CP7.52741	\$990	6208	208-230 460	89.5	8.60	18.00	187
	1800	213TC	CP7.54757	\$979	6208		91.7	8.90	18.00	204
	1200	254TC	CP7.66773	\$1,511	6309		91.0	9.70	23.45	299
10	3600	215TC	CP102742	\$1,121	6208	208-230 460	90.2	11.2	20.00	210
	1800	215TC	CP104758	\$1,132	6208		91.7	11.8	20.00	230
	1200	256TC	CP106774	\$1,792	6309		91.0	12.9	25.20	337
15	3600	254TC	CP152743	\$1,850	6309	208-230 460	91.0	16.6	23.45	329
	1800	254TC	CP154759	\$1,648	6309		92.4	17.1	23.45	332
	1200	284TC	CP156775	\$2,314	6311		91.7	18.4	26.60	476
20	3600	256TC	CP202744	\$2,027	6309	208-230 460	91.0	22.1	25.20	351
	1800	256TC	CP204760	\$1,961	6309		93.0	22.6	25.20	393
	1200	286TC	CP206776	\$2,682	6311		91.7	24.4	28.10	536
25	3600	284TSC	CP252745	\$2,238	6311	208-230 460	91.7	27.4	25.20	497
	1800	284TC	CP254761	\$2,413	6311		93.6	28.0	26.60	524
	1200	324TC	CP256777	\$3,430	6312		93.0	39.9	31.70	659
30	3600	286TSC	CP302746	\$2,650	6311	208-230 460	91.7	32.9	26.70	527
	1800	286TC	CP304762	\$2,790	6311		93.6	33.4	28.10	656
	1200	326TC	CP306778	\$3,672	6312		93.0	36.0	33.30	679
40	3600	324TSC	CP402747	\$3,555	6312	230 460	92.4	44.3	30.20	651
	1800	324TC	CP404763	\$3,574	6312		94.1	45.2	31.70	715
	1200	364TC	CP406779	\$4,411	6314		94.1	46.4	33.70	932
50	3600	326TSC	CP502748	\$3,978	6312	230 460	93.0	54.8	31.50	762
	1800	326TC	CP504764	\$4,174	6312		94.5	55.9	33.30	811
	1200	365TC	CP506780	\$5,524	6314		94.1	57.8	37.10	1020



CC068A

ISO9001

RoHS Compliant

Suitable for horizontal or vertical mounting

Reliable Electric Motor Company - Motors manufactured exclusively by Wannan Motor

release - July 1, 2014

# Premium Efficient C-face 3 phase motors



TEFC - rigid base - cast iron frame, brackets & conduit box

**Features:** 60/50 hertz, 1.15 service factor, class F insulation, class B temperature rise, NEMA design B starting, lip seals, epoxy paint, VPI impregnated windings, full length mounting feet.

bulletin - #228

**1 - 250 hp**

**Applications Include:** pumps, fans, blowers, saw mills, HVAC equipment, machine tools, conveyors and other C-face applications where duty cycle requires continuous operation.



Suitable for inverter use @ 20:1 variable torque or 10:1 constant torque.

Apply anywhere high quality - reliable performance is required.

HP	RPM	Frame	Catalog #	List Price	DE Bearing	Voltage	Rated Eff %	FL Amps	"C" Dim	Ship Wt.
60	3600	364TSC	CP602749	\$5,155	6314	208-230 460	93.6	64.3	31.50	940
	1800	364TC	CP604765	\$5,054	6314		95.0	67.0	33.70	995
	1200	404TC	CP606781	\$6,828	6316		94.5	68.4	38.00	1211
75	3600	365TSC	CP752750	\$5,786	6314	208-230 460	93.6	80.4	34.65	1070
	1800	365TC	CP754766	\$5,636	6314		95.4	83.2	37.10	1078
	1200	405TC	CP756782	\$7,400	6316		94.5	85.1	38.00	1377
100	3600	405TSC	CP1002751	\$7,379	6316	208-230 460	94.1	107	35.00	1310
	1800	405TC	CP1004767	\$7,635	6316		95.4	112	38.00	1328
	1200	444TC	CP1006783	\$11,469	6318		95.0	115	45.10	1711
125	3600	444TSC	CP1252793	\$11,189	6318	460	95.0	136	41.40	1705
	1800	445TC	CP1254797	\$10,993	6318		95.4	136	45.10	1699
	1200	445TC	CP1256801	\$12,667	6318		95.0	142	44.75	1865
150	3600	445TSC	CP1502794	\$13,361	6318	460	95.0	163	41.40	1750
	1800	445TC	CP1504798	\$13,141	6318		95.8	162	45.10	2013
	1200	447TC	CP1506802	\$15,278	6320		95.8	169	53.60	2382
200	3600	447TSC	CP2002795	\$16,407	6320	460	95.4	214	50.00	2349
	1800	447TC	CP2004799	\$16,985	6320		96.2	215	53.60	2232
	1200	449TC	CP2006803	\$19,102	6320		95.8	224	54.75	2646
250	3600	449TSC	CP2502796	\$19,166	6320	460	95.8	266	50.00	2479
	1800	449TC	CP2504800	\$19,372	6320		96.2	267	54.75	2477



CC068A

ISO9001

RoHS Compliant

Suitable for horizontal or vertical mounting

# Design C EAct Efficient 3 phase motors



TEFC - rigid base - cast iron frame, brackets & conduit box

**Features:** 60/50 hertz, 1.15 service factor, class F insulation, class B temperature rise, NEMA design B starting, lip seals, epoxy paint, VPI impregnated windings, full length mounting feet.

bulletin - #200

**1 - 200 hp**

**Applications Include:** pumps, fans, blowers, saw mills, HVAC equipment, machine tools, compressors and other applications where duty cycle requires continuous operation.

Suitable for inverter use @ 10:1 variable torque or 5:1 constant torque.

Apply anywhere high quality - reliable performance is required.

HP	RPM	Frame	Catalog #	List Price	DE Bearing	Voltage	Rated Eff %	FL Amps	"C" Dim	Ship Wt.
1	3600	143T	AC012100	\$320	6205	208-230 460	75.5	1.30	12.50	53
	1800	143T	AC014100	\$342	6205		82.5	1.52	12.50	56
	1200	145T	AC016100	\$392	6205		80.0	1.75	13.50	68
1.5	3600	143T	AC1.52101	\$347	6205	208-230 460	82.5	2.00	12.50	55
	1800	145T	AC1.54101	\$380	6205		84.0	2.20	13.50	62
	1200	182T	AC1.56101	\$587	6206		85.5	2.20	15.30	88
2	3600	145T	AC022102	\$388	6205	208-230 460	84.0	2.70	13.50	64
	1800	145T	AC024102	\$398	6205		84.0	2.80	13.50	64
	1200	184T	AC026102	\$668	6306		86.5	3.00	18.00	95
3	3600	182T	AC032103	\$582	6306	208-230 460	85.5	3.80	15.30	90
	1800	182T	AC034103	\$573	6306		87.5	4.10	15.30	94
	1200	213T	AC036103	\$847	6208		87.5	4.20	18.00	144
5	3600	184T	AC052104	\$637	6306	208-230 460	87.5	6.10	18.00	99
	1800	184T	AC054104	\$632	6306		87.5	6.50	18.00	107
	1200	215T	AC056104	\$973	6208		87.5	7.10	22.50	155
7.5	3600	213T	AC7.52105	\$928	6208	208-230 460	88.5	8.90	18.00	155
	1800	213T	AC7.54105	\$929	6208		89.5	9.40	18.00	169
	1200	254T	AC7.56105	\$1,416	6309		89.5	10.60	23.40	250
10	3600	215T	AC102106	\$1,060	6208	208-230 460	89.5	11.6	22.50	175
	1800	215T	AC104106	\$1,054	6208		89.5	12.5	22.50	192
	1200	256T	AC106106	\$1,614	6309		89.5	13.7	25.10	283
15	3600	254T	AC152107	\$1,734	6309	208-230 460	90.2	17.6	23.40	276
	1800	254T	AC154107	\$1,469	6309		91.0	18.6	23.40	279
	1200	284T	AC156107	\$2,185	6311		90.2	19.3	28.00	397
20	3600	256T	AC202108	\$1,821	6309	208-230 460	90.2	23.2	25.10	295
	1800	256T	AC204108	\$1,753	6309		91.0	24.8	25.10	332
	1200	286T	AC206108	\$2,418	6311		90.2	25.8	29.50	449
25	3600	284TS	AC252109	\$2,116	6311	208-230 460	91.0	28.9	26.50	415
	1800	284T	AC254109	\$2,310	6311		92.4	29.6	28.00	439
	1200	324T	AC256109	\$3,038	6312		91.7	31.9	30.30	552
30	3600	286TS	AC302110	\$2,257	6311	208-230 460	91.0	34.5	28.00	441
	1800	286T	AC304110	\$2,510	6311		92.4	35.5	29.50	474
	1200	326T	AC306110	\$3,273	6312		91.7	38.0	31.80	569
40	3600	324TS	AC402111	\$3,237	6312	230 460	91.7	46.5	28.00	545
	1800	324T	AC404111	\$3,180	6312		93.0	47.1	30.30	591
	1200	364T	AC406111	\$4,200	6314		93.0	47.4	33.15	787
50	3600	326TS	AC502112	\$3,441	6312	230 460	92.4	58.5	30.30	642
	1800	326T	AC504112	\$3,729	6312		93.0	59.2	31.80	684
	1200	365T	AC506112	\$4,832	6314		93.0	59.2	34.15	864



CC068A

ISO9001

RoHS Compliant

Suitable for horizontal or vertical mounting

Reliable Electric Motor Company - Motors manufactured exclusively by Wannan Motor

release - July 1, 2014

# Design C EAct Efficient 3 phase motors



TEFC - rigid base - cast iron frame, brackets & conduit box

**Features:** 60/50 hertz, 1.15 service factor, class F insulation, class B temperature rise, NEMA design B starting, lip seals, epoxy paint, VPI impregnated windings, full length mounting feet.

bulletin - #200

**1 - 200 hp**

**Applications Include:** pumps, fans, blowers, saw mills, HVAC equipment, machine tools, compressors and other applications where duty cycle requires continuous operation.

Suitable for inverter use @ 10:1 variable torque or 5:1 constant torque.

Apply anywhere high quality - reliable performance is required.

HP	RPM	Frame	Catalog #	List Price	DE Bearing	Voltage	Rated Eff %	FL Amps	"C" Dim	Ship Wt.
60	3600	364TS	AC602113	\$4,732	6314	230 460	93.0	67.5	31.02	794
	1800	364T	AC604113	\$4,499	6314		93.6	69.4	33.15	842
	1200	404T	AC604113	\$6,059	6216		93.6	70.0	37.00	1019
75	3600	365TS	AC752114	\$5,162	6214	230 460	93.0	84.3	32.02	913
	1800	365T	AC754114	\$5,213	6214		94.1	86.2	33.15	914
	1200	405T	AC756114	\$6,693	6216		93.6	87.7	37.00	1169
100	3600	405TS	AC1002115	\$6,352	6316	230 460	93.6	100	32.02	1107
	1800	405T	AC1004115	\$6,883	6316		94.5	114	34.15	1127
	1800	405T	AC1004326	\$6,986	NU316		94.5	114	34.15	1127
	1200	444T	AC1006115	\$10,254	6318		94.1	116	38.50	1455
	1200	444T	AC1006332	\$10,339	NU318		94.1	116	38.50	1455
125	3600	444TS	AC1252346	\$10,001	6318	460	94.5	137	39.00	1449
	1800	444T	AC1254116	\$9,599	6318		94.5	141	42.75	1433
	1800	444T	AC1254327	\$9,734	NU318		94.5	141	42.75	1433
	1200	445T	AC1256116	\$11,330	6218		94.1	145	44.75	1588
	1200	445T	AC1256333	\$11,491	NU318		94.1	145	44.75	1588
150	3600	445TS	AC1502347	\$11,944	6318	460	94.5	164	41.00	1488
	1800	445T	AC1504117	\$11,482	6318		95.0	169	44.75	1716
	1800	445T	AC1504328	\$11,664	NU318		95.0	169	44.75	1716
	1200	447T	AC1506117	\$13,656	6320		95.0	170	48.25	2037
	1200	447T	AC1506334	\$13,849	NU320		95.0	170	48.25	2037
200	3600	447TS	AC2002348	\$14,344	6320	460	95.0	215	44.50	2009
	1800	447T	AC2004118	\$15,047	6320		95.0	223	48.25	1907
	1800	447T	AC2004329	\$15,261	NU320		95.0	223	48.25	1907
	1200	449T	AC2006118	\$17,083	6320		95.0	258	53.25	2267
	1200	449T	AC2006335	\$17,325	NU320		95.0	258	53.25	2267



CC068A

ISO9001

RoHS Compliant

Suitable for horizontal or vertical mounting

# Design C EPAct Efficient C-face 3 phase motors



TEFC - rigid base - cast iron frame, brackets & conduit box

**Features:** 60/50 hertz, 1.15 service factor, class F insulation, class B temperature rise, NEMA design B starting, lip seals, epoxy paint, VPI impregnated windings, full length mounting feet.

bulletin - #220

## 1 - 200 hp

**Applications Include:** pumps, fans, blowers, conveyors, machine tools, gear reducers and other C-face applications where duty cycle requires continuous operation.

Suitable for inverter use @ 10:1 variable torque or 5:1 constant torque.

Apply anywhere high quality - reliable performance is required.

HP	RPM	Frame	Catalog #	List Price	DE Bearing	Voltage	Rated Eff %	FL Amps	"C" Dim	Ship Wt.
1	3600	143TC	CC012100	\$331	6205	208-230 460	75.5	1.30	12.50	56
	1800	143TC	CC014100	\$352	6205		82.5	1.52	12.50	59
	1200	145TC	CC016100	\$405	6205		80.0	1.75	13.50	71
1.5	3600	143TC	CC1.52101	\$358	6205	208-230 460	82.5	2.00	12.50	58
	1800	145TC	CC1.54101	\$392	6205		84.0	2.20	12.50	65
	1200	182TC	CC1.56101	\$605	6206		85.5	2.20	13.50	92
2	3600	145TC	CC022102	\$400	6205	208-230 460	84.0	2.70	13.50	67
	1800	145TC	CC024102	\$410	6205		84.0	2.80	13.50	67
	1200	184TC	CC026102	\$689	6306		86.5	3.00	18.00	99
3	3600	182TC	CC032103	\$600	6306	208-230 460	85.5	3.80	15.30	94
	1800	182TC	CC034103	\$591	6306		87.5	4.10	15.30	95
	1200	213TC	CC036103	\$874	6208		87.5	4.20	18.00	152
5	3600	184TC	CC052104	\$656	6306	208-230 460	87.5	6.10	18.00	103
	1800	184TC	CC054104	\$662	6306		87.5	6.50	18.00	111
	1200	215TC	CC056104	\$1,003	6208		87.5	7.10	22.50	163
7.5	3600	213TC	CC7.52105	\$957	6208	208-230 460	88.5	8.90	18.00	163
	1800	213TC	CC7.54105	\$959	6208		89.5	9.40	18.00	177
	1200	254TC	CC7.56105	\$1,459	6309		89.5	10.60	23.40	260
10	3600	215TC	CC102106	\$1,093	6208	208-230 460	89.5	11.6	22.50	183
	1800	215TC	CC104106	\$1,087	6208		89.5	12.5	22.500	200
	1200	256TC	CC106392	\$1,663	6309		89.5	13.7	25.10	293
15	3600	254TC	CC152107	\$1,787	6309	208-230 460	90.2	17.6	23.40	286
	1800	254TC	CC154107	\$1,513	6309		91.0	18.6	23.40	289
	1200	284TC	CC156107	\$2,253	6311		90.2	19.3	28.00	414
20	3600	256TC	CC202108	\$1,876	6309	208-230 460	90.2	23.2	25.10	305
	1800	256TC	CC204108	\$1,806	6309		91.0	24.8	25.10	342
	1200	286TC	CC206393	\$2,491	6311		90.2	25.8	29.50	466
25	3600	284TSC	CC252109	\$2,181	6311	208-230 460	91.0	28.9	26.50	432
	1800	284TC	CC254109	\$2,381	6311		92.4	29.6	28.00	456
	1200	324TC	CC256394	\$3,131	6312		91.7	31.9	30.30	573
30	3600	286TSC	CC302110	\$2,326	6311	208-230 460	91.0	34.5	28.00	458
	1800	286TC	CC304110	\$2,587	6311		92.4	35.5	29.50	491
	1200	326TC	CC306395	\$3,372	6312		91.7	38.0	31.80	590
40	3600	324TSC	CC402111	\$3,336	6312	230 460	91.7	46.5	28.00	566
	1800	324TC	CC404111	\$3,281	6312		93.0	47.1	30.30	622
	1200	364TC	CC406396	\$4,325	6314		93.0	47.4	33.15	887
50	3600	326TSC	CC502112	\$3,545	6312	230 460	92.4	58.5	30.30	663
	1800	326TC	CC504112	\$3,841	6312		93.0	59.5	31.80	865
	1200	365TC	CC506397	\$4,976	6314		93.0	59.5	34.15	887



CC068A

ISO9001

RoHS Compliant

Suitable for horizontal or vertical mounting

Reliable Electric Motor Company - Motors manufactured exclusively by Wannan Motor

release - July 1, 2014



# Design C EPCo Efficient C-face 3 phase motors



TEFC - rigid base - cast iron frame, brackets & conduit box

**Features:** 60/50 hertz, 1.15 service factor, class F insulation, class B temperature rise, NEMA design B starting, lip seals, epoxy paint, VPI impregnated windings, full length mounting feet.

bulletin - #220

**1 - 200 hp**

**Applications Include:** pumps, fans, blowers, conveyors, machine tools, gear reducers and other C-face applications where duty cycle requires continuous operation.

Suitable for inverter use @ 10:1 variable torque or 5:1 constant torque.

Apply anywhere high quality - reliable performance is required.

HP	RPM	Frame	Catalog #	List Price	DE Bearing	Voltage	Rated Eff %	FL Amps	"C" Dim	Ship Wt.
60	3600	364TSC	CC602113	\$4,874	6214	230 460	93.0	67.5	31.02	817
	1800	364TC	CC604113	\$4,633	6214		93.6	69.4	33.15	865
	1200	404TC	CC606398	\$6,242	6216		93.6	70.0	37.00	1047
75	3600	365TSC	CC752114	\$5,312	6214	230 460	93.0	84.3	32.02	930
	1800	365TC	CC754114	\$5,367	6214		94.1	86.2	34.15	865
	1200	405TC	CC756399	\$6,891	6216		93.6	87.7	38.50	1197
100	3600	405TSC	CC1002115	\$6,542	6316	230 460	93.6	100	34.50	1135
	1800	405TC	CC1004115	\$7,187	6316		94.5	114	38.50	1155
	1200	444TC	CC1006400	\$10,707	6318		94.1	116	42.75	1488
125	3600	444TS	CC1252804	\$10,298	6318	460	94.5	137	39.00	1483
	1800	444T	CC1254323	\$10,026	6318		94.5	141	42.75	1477
	1200	445T	CC1256811	\$11,830	6218		94.1	145	44.75	1622
150	3600	445TS	CC1502805	\$12,298	6318	460	94.5	164	41.00	1522
	1800	445T	CC1504324	\$11,986	6318		95.0	169	44.75	1750
	1200	447T	CC1506812	\$14,253	6320		95.0	170	48.25	2071
200	3600	447TS	CC2002806	\$14,764	6320	460	95.0	215	44.50	2043
	1800	447T	CC2004808	\$15,710	6320		95.0	223	48.25	1941
	1200	449T	CC2006813	\$17,831	6320		95.0	258	53.25	2301



CC068A

ISO9001

RoHS Compliant

Suitable for horizontal or vertical mounting

# Quarry & Mill Crusher Duty 3 phase motors



TEFC - rigid base - cast iron frame, brackets & conduit box

**Features:** Extra heavy duty frame & brackets, 4140 shaft, oversized roller bearing on DE, epoxy paint, VPI impregnated windings, full length mounting feet, suitable for inverter use @ 10:1 VT or 5:1 CT.

bulletin - #223

**1 - 600 hp**

**Applications Include:** *impact-cones, jaw or roller crushers, hammermills, feeders, cage mill conveyors, or any other applications where duty cycle requires continuous heavy duty operation.*

**Ratings 100 - 200 hp in 1800 & 1200 rpm are NEMA Premium Efficient - all others are EPACT Efficient per Federal Regulatory changes of 2011.**

HP	RPM	Frame	Catalog #	List Price	Shaft "U" Dim	Voltage	Rated Eff %	FL Amps	"C" Dim	Ship Wt.
100	1800	405T	AP1004784	\$7,463	2.875	230 460	95.4	112	38.00	1296
	1200	444T	AP1006789	\$11,296	3.375		95.0	115	45.10	1673
	900	445T	A1008630	\$11,440	3.375		93.0	133	44.75	1621
125	1800	444T	AP1254785	\$10,822	3.375	460	95.4	136	45.10	1648
	1200	445T	AP1256790	\$12,487	3.375		95.0	142	45.10	1826
	900	447T	A1258631	\$13,346	3.375		93.6	165	48.25	2037
150	1800	445T	AP1504786	\$12,945	3.375	460	95.8	162	45.10	1973
	1200	447T	AP1506791	\$15,053	3.375		95.8	169	53.60	2343
	900	449T	A1508632	\$15,567	3.375		93.6	198	53.25	2256
200	1800	447T	AP2004787	\$16,249	3.375	460	96.2	215	53.60	2193
	1200	449T	AP2006792	\$19,089	3.375		95.8	224	54.75	2607
	900	587UZ	A2008897	\$25,249	3.375		94.1	240	69.34	3687
250	1800	449T	AP2504788	\$19,089	3.375	460	96.2	267	54.75	2477
	1200	587UZ	A2506336	\$24,832	3.875		95.0	287	69.34	3870
	1200	587UZ	A2506606	\$24,832	4.375		95.0	287	69.34	3870
	900	587UZ	A2508898	\$27,887	3.875		94.5	300	69.34	3991
300	1800	587UZ	A3004331	\$23,282	3.875	460	95.0	332	69.34	3888
	1800	587UZ	A3004597	\$23,282	4.375		95.0	332	69.34	3888
	1200	587UZ	A3006337	\$26,291	3.875		95.0	344	69.34	4117
	1200	587UZ	A3006602	\$26,291	4.375		95.0	344	69.34	4117
	900	587UZ	A3008899	\$30,485	3.875		95.0	361	69.34	4309
350	1800	587UZ	A3504338	\$24,581	3.875	460	94.0	388	69.34	3980
	1800	587UZ	A3504598	\$24,581	4.375		94.0	388	69.34	3980
	1200	587UZ	A3506342	\$29,175	3.875		95.0	401	69.34	4516
	1200	587UZ	A3506603	\$29,175	4.375		95.0	401	69.34	4516
	900	588UZ	A3508900	\$35,792	3.875		94.5	421	79.19	4801
400	1800	587UZ	A4004339	\$25,769	3.875	460	94.0	443	69.34	4117
	1800	587UZ	A4004599	\$25,769	4.375		94.0	443	69.34	4117
	1200	587UZ	A4006343	\$31,354	3.875		95.0	458	69.34	4673
	1200	587UZ	A4006604	\$31,354	4.375		95.0	458	69.34	4673
	900	588UZ	A4008901	\$42,747	3.875		94.5	481	79.19	5118
450	1800	587UZ	A4504340	\$30,871	3.875	460	95.0	498	69.34	4677
	1800	587UZ	A4504600	\$31,871	4.375		95.0	498	69.34	4677
	1200	588UZ	A4506344	\$36,908	3.875		95.0	516	79.19	5158
	1200	588UZ	A4506605	\$36,908	4.375		94.5	516	79.19	5158
500	1800	588UZ	A5004341	\$36,927	3.875	460	95.0	554	79.19	5074
	1800	588UZ	A5004601	\$36,927	4.375		95.0	554	79.19	5074
	1200	588UZ	A5006345	\$43,496	3.875		95.0	573	79.19	5526
	1200	588UZ	A5006596	\$43,496	4.375		94.5	573	79.19	5526
600	1800	588UZ	A6004660	\$40,777	4.375	460	95.0	664	79.19	5286



CC068A

ISO9001

RoHS Compliant

Suitable for horizontal or vertical mounting



# JM Pump EAct Efficient 3 phase motors



TEFC - rigid base - cast iron frame, brackets & conduit box

Features: 60/50 hertz, 1.15 service factor, class F insulation, class B temperature rise, NEMA design B starting, lip seals, epoxy paint, VPI impregnated windings, full length mounting feet.

bulletin - #240

1 - 100 hp

Applications: specifically designed for close-coupled circulating or transfer pumps that utilize JM shaft and C-face mount, continuous duty and where superior performance is expected.

Suitable for inverter use @ 10:1 variable torque or 5:1 constant torque. Apply anywhere high quality - reliable performance is required.

HP	RPM	Frame	Catalog #	List Price	DE Bearing	Voltage	Rated Eff %	FL Amps	"C" Dim	Ship Wt.
1	3600	143JM	JA012658	\$314	6206	208-230 460	75.5	1.30	14.66	56
	1800	143JM	JA014318	\$322	6206		82.5	1.52	14.66	59
	1200	145JM	JA016663	\$372	6206		80.0	1.75	15.66	71
1.5	3600	143JM	JA1.52289	\$328	6206	208-230 460	82.5	2.00	14.66	58
	1800	145JM	JA1.54301	\$357	6206		84.0	2.20	15.66	65
	1200	182JM	JA1.56666	\$522	6207		85.5	2.20	16.16	92
2	3600	145JM	JA022290	\$364	6206	208-230 460	84.0	2.70	15.66	67
	1800	145JM	JA024302	\$371	6206		84.0	2.80	15.66	67
	1200	184JM	JA026669	\$577	6207		86.5	3.00	17.46	99
3	3600	145JM	JA032862	\$439	6206	208-230 460	85.5	3.80	15.66	80
	3600	182JM	JA032291	\$533	6207		85.5	3.80	16.16	94
	1800	145JM	JA034866	\$444	6206		87.5	4.10	15.66	81
	1800	182JM	JA034303	\$584	6207		87.5	4.10	16.16	99
	1200	213JM	JA036671	\$818	6209		87.5	4.20	20.16	152
5	3600	184JM	JA052292	\$602	6207	208-230 460	87.5	6.10	17.46	103
	1800	184JM	JA054304	\$625	6207		87.5	6.50	17.46	111
	1200	215JM	JA056675	\$917	6209		87.5	7.10	23.66	163
7.5	3600	184JM	JA7.52863	\$748	6207	208-230 460	88.5	8.90	17.46	124
	3600	213JM	JA7.52293	\$872	6209		88.5	8.90	20.16	163
	1800	184JM	JA7.54867	\$801	6207		89.5	9.40	17.46	134
	1800	213JM	JA7.54305	\$928	6209		89.5	9.40	20.16	172
	1200	254JM	JA7.56665	\$1,298	6309		89.5	10.60	24.93	260
10	3600	215JM	JA102294	\$998	6209	208-230 460	89.5	11.6	23.66	183
	1800	215JM	JA104306	\$1,034	6209		89.5	12.5	23.66	192
	1200	256JM	JA106662	\$1,521	6309		89.5	13.7	26.63	293
15	3600	215JM	JA152494	\$1,197	6209	208-230 460	90.2	17.6	23.66	220
	3600	254JM	JA152295	\$1,590	6309		90.2	17.6	24.93	286
	1800	215JM	JA154868	\$1,384	6209		91.1	18.6	23.66	231
	1800	254JM	JA154307	\$1,539	6309		91.0	18.6	24.93	289
	1200	284JM	JA156667	\$1,990	6310		90.2	19.3	27.38	414
20	3600	256JM	JA202296	\$1,741	6309	208-230 460	90.2	23.2	26.63	305
	1800	256JM	JA204308	\$1,763	6309		91.0	24.8	26.63	342
	1200	286JM	JA206672	\$2,297	6310		90.2	25.8	28.88	445
25	3600	256JM	JA252864	\$2,093	6309	208-230 460	91.0	28.9	26.63	366
	3600	284JM	JA252297	\$1,899	6310		91.0	28.9	27.38	432
	1800	256JM	JA254869	\$2,208	6309		92.4	29.6	26.63	411
	1800	284JM	JA254309	\$2,052	6310		92.4	29.6	27.38	456
	1200	324JM	JA256676	\$2,647	6312		91.7	31.9	28.53	557



CC068A

ISO9001

RoHS Compliant

Suitable for horizontal or vertical mounting

# JM Pump EAct Efficient 3 phase motors



TEFC - rigid base - cast iron frame, brackets & conduit box

**Features:** 60/50 hertz, 1.15 service factor, class F insulation, class B temperature rise, NEMA design B starting, lip seals, epoxy paint, VPI impregnated windings, full length mounting feet.

bulletin - #240

## 1 - 100 hp

**Applications:** *specifically designed for close-coupled circulating or transfer pumps that utilize JM shaft and C-face mount, continuous duty and where superior performance is expected.*

**Suitable for inverter use @ 10:1 variable torque or 5:1 constant torque.  
Apply anywhere high quality - reliable performance is required.**

HP	RPM	Frame	Catalog #	List Price	DE Bearing	Voltage	Rated Eff %	FL Amps	"C" Dim	Ship Wt.
30	3600	286JM	JA302298	\$2,212	6310	208-230 460	91.0	34.5	28.88	458
	1800	286JM	JA304310	\$2,374	6310		91.4	35.5	28.88	491
	1200	326JM	JA306674	\$3,035	6312		91.7	38.0	30.03	590
40	3600	286JM	JA402865	\$2,709	6310	230 460	91.7	46.5	28.88	550
	3600	324JM	JA402299	\$3,049	6312		91.7	46.5	28.83	629
	1800	286JM	JA404870	\$3,058	6310		93.0	47.1	28.88	590
	1800	324JM	JA404311	\$2,817	6312		93.0	47.1	28.53	622
	1200	364JM	JA406668	\$4,011	6314		93.0	47.4	34.93	810
50	3600	326JM	JA502300	\$3,403	6312	230 460	92.4	58.5	30.03	663
	1800	326JM	JA504312	\$3,405	6312		93.0	59.2	30.03	705
	1200	365JM	JA506670	\$4,884	6314		93.0	59.2	35.93	861
60	3600	364JM	JA602319	\$4,444	6314	230 460	93.0	67.5	34.93	817
	1800	364JM	JA604321	\$4,192	6314		93.6	69.4	34.93	865
	1200	404JM	JA606664	\$6,054	6316		93.6	70.0	37.00	1053
75	3600	365JM	JA752320	\$4,960	6314	230 460	93.0	84.3	35.93	930
	1800	365JM	JA754322	\$4,842	6314		94.1	86.2	35.93	896
	1200	405JM	JA756661	\$6,882	6316		93.6	87.7	37.00	1197
100	3600	405JM	JA1002659	\$6,414	6316	230 460	93.6	100	37.00	1139
	1800	405JM	JA1004656	\$6,276	6316		94.5	114	37.00	1190



CC068A

ISO9001

RoHS Compliant

Suitable for horizontal or vertical mounting

# JM Pump Premium Efficient 3 phase motors



TEFC - rigid base - cast iron frame, brackets & conduit box

**Features:** 60/50 hertz, 1.15 service factor, class F insulation, class B temperature rise, NEMA design B starting, lip seals, epoxy paint, VPI impregnated windings, full length mounting feet.

bulletin - #241

## 1 - 100 hp

**Applications:** specifically designed for close-coupled circulating or transfer pumps that utilize JM shaft and C-face mount, continuous duty and where superior performance is expected



Suitable for inverter use @ 20:1 variable torque or 10:1 constant torque.

Apply anywhere high quality - reliable performance is required.

HP	RPM	Frame	Catalog #	List Price	DE Bearing	Voltage	Rated Eff %	FL Amps	"C" Dim	Ship Wt.
1	3600	143JM	JP012658	\$380	6206	208-230 460	77.0	1.50	15.66	64
	1800	143JM	JP014318	\$389	6206		85.5	1.43	15.66	68
	1200	145JM	JP016663	\$449	6206		82.5	1.60	16.66	82
1.5	3600	143JM	JP1.52289	\$401	6206	208-230 460	84.0	1.88	15.66	67
	1800	145JM	JP1.54301	\$422	6206		86.5	2.08	16.66	75
	1200	182JM	JP1.56666	\$617	6207		87.5	2.12	17.16	106
2	3600	145JM	JP022290	\$444	6206	208-230 460	85.5	2.40	16.66	77
	1800	145JM	JP024302	\$452	6206		86.5	2.70	18.66	77
	1200	184JM	JP026669	\$683	6207		88.5	2.80	18.46	114
3	3600	182JM	JP032291	\$630	6207	208-230 460	86.5	3.60	17.16	108
	1800	182JM	JP034701	\$588	6207		89.5	3.70	17.16	114
	1200	213JM	JP036671	\$967	6209		89.5	4.00	21.16	175
5	3600	184JM	JP052292	\$711	6307	208-230 460	88.5	5.90	18.46	118
	1800	184JM	JP054702	\$689	6307		89.5	6.10	18.46	128
	1200	215JM	JP056675	\$1,111	6209		89.5	6.40	24.66	187
7.5	3600	213JM	JP7.52293	\$1,030	6209	208-230 460	89.5	8.60	21.16	187
	1800	213JM	JP7.54703	\$997	6209		91.7	8.90	21.16	204
	1200	254JM	JP7.56665	\$1,538	6309		91.0	9.70	25.93	268
10	3600	215JM	JP102294	\$1,179	6209	208-230 460	90.2	11.2	24.66	210
	1800	215JM	JP104704	\$1,154	6209		91.7	11.8	24.66	230
	1200	256JM	JP106662	\$1,885	6309		91.0	12.9	27.63	337
15	3600	254JM	JP152295	\$1,946	6309	208-230 460	91.0	16.6	25.93	329
	1800	254JM	JP154705	\$1,678	6309		92.4	17.1	25.93	332
	1200	284JM	JP156667	\$2,434	6311		91.7	18.4	28.38	476
20	3600	256JM	JP202685	\$2,132	6309	208-230 460	91.0	22.1	27.63	351
	1800	256JM	JP204706	\$1,996	6309		93.0	22.6	27.63	393
	1200	286JM	JP206672	\$2,821	6311		91.7	24.4	29.88	536
25	3600	284JM	JP252297	\$2,328	6311	208-230 460	91.7	27.4	28.38	497
	1800	284JM	JP254705	\$2,456	6311		93.6	28.0	28.38	524
	1200	324JM	JP256676	\$3,549	6312		93.0	39.9	29.53	659
30	3600	286JM	JP302298	\$2,757	6311	208-230 460	91.7	32.9	29.88	527
	1800	286JM	JP304708	\$2,791	6311		93.6	33.4	29.88	565
	1200	326JM	JP306674	\$3,744	6312		93.0	36.0	31.03	695
40	3600	324JM	JP402299	\$3,699	6312	230 460	92.4	44.3	29.83	651
	1800	324JM	JP404709	\$3,575	6312		94.1	45.2	29.83	715
	1200	364JM	JP406668	\$4,489	6314		94.1	46.4	35.93	932
50	3600	326JM	JP502300	\$4,140	6312	230 460	93.0	54.8	31.03	762
	1800	326JM	JP504312	\$4,250	6312		94.5	55.9	31.03	811
	1200	365JM	JP506670	\$5,623	6314		94.1	57.8	36.93	1020



CC068A

ISO9001

RoHS Compliant

Suitable for horizontal or vertical mounting

Reliable Electric Motor Company - Motors manufactured exclusively by Wannan Motor

release - July 1, 2014

# JM Pump Premium Efficient 3 phase motors



TEFC - rigid base - cast iron frame, brackets & conduit box

**Features:** 60/50 hertz, 1.15 service factor, class F insulation, class B temperature rise, NEMA design B starting, lip seals, epoxy paint, VPI impregnated windings, full length mounting feet.

bulletin - #241

**1 - 100 hp**

**Applications:** *specifically designed for close-coupled circulating or transfer pumps that utilize JM shaft and C-face mount, continuous duty and where superior performance is expected*



**Suitable for inverter use @ 20:1 variable torque or 10:1 constant torque.**

**Apply anywhere high quality - reliable performance is required.**

HP	RPM	Frame	Catalog #	List Price	DE Bearing	Voltage	Rated Eff %	FL Amps	"C" Dim	Ship Wt.
60	3600	364JM	JP602319	\$5,364	6314	230 460	93.6	64.3	35.93	940
	1800	364JM	JP604321	\$5,145	6314		67.0	67.0	35.93	995
	1200	404JM	JP606664	\$6,950	6316		68.4	68.4	37.00	1211
75	3600	365JM	JP752320	\$6,020	6314	230 460	80.4	80.4	36.93	1070
	1800	365JM	JP754322	\$5,909	6314		83.2	83.2	36.93	1078
	1200	405JM	JP756661	\$7,532	6316		85.1	85.1	37.00	1377
100	3600	405JM	JP1002659	\$7,679	6316	230 460	94.1	107	37.00	1310
	1800	405JM	JP1004656	\$7,991	6316		95.4	112	37.00	1286

Suitable for horizontal or vertical mounting

# Design D - Oil Well Pump 3 phase motors



TEFC - rigid base - cast iron frame, brackets & conduit box

**Features:** high torque NEMA design for 5-8% slip, F2 conduit box location, lip seals, epoxy paint, VPI impregnated windings, 12 leads through 20 hp - 6 leads through 150 hp, full length mounting feet.

bulletin - #224

## 3 - 150 hp

**Applications Include:** oil well pump equipment, punch presses, any other applications where high starting torque and high quality performance is required.

HP	RPM	Frame	Catalog #	List Price	DE Bearing	Voltage	Rated Eff %	FL Amps	"C" Dim	Ship Wt.
3	1200	213T	W036279	\$856	6208	230/460 796 start	79.0	4.65	22.50	156
5	1200	215T	W056817	\$999	6208		80.0	7.50	22.50	186
7.5	1200	254T	W7.56281	\$1,365	6309		86.5	10.0	25.10	284
10	1200	256T	W106818	\$1,634	6309		84.0	13.5	25.10	340
15	1200	284T	W156283	\$2,088	6310		87.1	20.0	29.50	442
20	1200	286T	W206819	\$2,441	6310		87.5	27.0	29.50	508
25	1200	324T	W256285	\$2,773	6312	460 796 start	89.0	33.0	31.80	584
30	1200	326T	W306820	\$3,018	6312		87.5	39.0	31.80	683
40	1200	365T	W406287	\$4,094	6314		89.5	51.0	34.15	906
50	1200	404T	W506288	\$5,014	6316		89.5	61.0	37.00	1018
60	1200	405T	W606289	\$6,054	6316		90.2	74.0	38.50	1168
75	1200	444T	W756313	\$6,947	6318		89.0	91.0	42.75	1484
100	1200	445T	W1006314	\$11,777	NU320		89.0	124	44.75	1652
125	1200	447T	W1256315	\$12,573	NU320		90.0	153	48.25	2035
150	1200	449T	W1506316	\$14,593	NU320		92.0	177	53.25	2253



CC068A

ISO9001

RoHS  
Compliant

Suitable for horizontal or vertical mounting

# Stainless Steel 3 phase motors



TEFC & TENV - all stainless construction - C-face on DE

**Features:** all 300 series exterior parts, 4 condensate drains, 60/50 hertz, 1.15 service factor, class F insulation, class B temperature rise, lip seals, VPI impregnated windings, **foot mounted.**

bulletin - #222

**1/4 - 2 hp**

**Applications include:** all washdown environments, food processing, outdoor marine, or other caustic applications requiring continuous duty operation.

Suitable for inverter use @ 10:1 variable torque or 5:1 constant torque.

Apply anywhere high quality - reliable performance is required.

HP	RPM	Frame	Catalog #	List Price	DE Bearing	Voltage	Rated Eff %	FL Amps	"C" Dim	Ship Wt.	
<b>TENV Construction</b>											
<b>1/4</b>	3600	56C	HSE0.252410	\$443	6205	208-230 460	70.0	0.42	10.00	28	
	1800	56C	HSE0.254417	\$469			74.0	0.45		29	
	1200	56C	HSE0.256424	\$484			68.0	0.56		29	
<b>1/3</b>	3600	56C	HSE0.332411	\$459		208-230 460	71.0	0.54	10.00	28	
	1800	56C	HSE0.334418	\$472			75.0	0.59		30	
	1200	56C	HSE0.336425	\$502			70.0	0.70		31	
<b>1/2</b>	3600	56C	HSE0.52412	\$477		208-230 460	74.0	0.77	10.00	31	
	1800	56C	HSE0.54419	\$495			77.0	0.82		32	
	1200	56C	HSE0.56426	\$519			74.0	0.96		34	
<b>3/4</b>	3600	56C	HSE0.752413	\$493		208-230 460	75.5	1.12	10.00	31	
	1800	56C	HSE0.754420	\$503			78.0	1.22		34	
	1200	56C	HSE0.756427	\$555			77.0	1.36		41	
<b>1</b>	3600	56C	HSE012463	\$520		208-230 460	82.5	1.35	12.00	37	
	1800	56C	HSE014466	\$520			82.5	1.52		37	
	1200	56C	HSE016469	\$572			80.0	1.72		44	
<b>TEFC Construction</b>											
<b>1/4</b>	3600	56C	HS0.252410	\$443	6205	208-230 460	70.0	0.42	12.00	30	
	1800	56C	HS0.254417	\$469			74.0	0.45		33	
	1200	56C	HS0.256424	\$484			68.0	0.56		32	
<b>1/3</b>	3600	56C	HS0.332411	\$459		208-230 460	71.0	0.54	12.00	30	
	1800	56C	HS0.334418	\$472			75.0	0.59		33	
	1200	56C	HS0.336425	\$502			70.0	0.70		35	
<b>1/2</b>	3600	56C	HS0.52412	\$477		208-230 460	74.0	0.77	12.00	33	
	1800	56C	HS0.54419	\$495			77.0	0.82		36	
	1200	56C	HS0.56426	\$519			74.0	0.96		38	
<b>3/4</b>	3600	56C	HS0.752413	\$493		208-230 460		1.12	1.12	12.00	33
	3600	143TC	CS0.752439	\$485				1.12	1.12		38
	1800	56C	HS0.754420	\$503				1.22	1.22		37
	1800	143TC	CS0.754451	\$487				1.22	1.22		41
	1200	56HC	HS0.756427	\$555				1.36	1.36		47
	1200	143TC	CS0.756462	\$572				1.36	1.36		47
<b>1</b>	3600	56HC	HS012463	\$520	208-230 460	1.35	1.35	14.00	42		
	1800	56HC	HS014466	\$520		1.52	1.52		42		
	1200	56HC	HS016469	\$572		1.72	1.72		50		
<b>1 1/2</b>	3600	56HC	HS1.52464	\$585		2.03	2.03	14.00	45		
	1800	56HC	HS1.54467	\$578		2.12	2.12		48		
	1200	56HC	HS1.56470	\$1,020		2.58	2.58		57		
<b>2</b>	3600	56HC	HS022465	\$686	208-230 460	2.59	2.59	14.00	51		
	1800	56HC	HS024468	\$679		2.78	2.78		52		



CC068A

ISO9001

RoHS Compliant

# Stainless Steel roundbody 3 phase motors



TEFC & TENV - all stainless steel construction - C-face on DE

**Features:** all 300 series exterior parts, 4 condensate drains, 60/50 hertz rated, 1.15 service factor, class F insulation, class B temperature rise, lip seals, VPI impregnated windings, **footless**.

bulletin - #243

## 1/4 - 30 Hp

**Applications include:** all washdown environments, pharmaceutical, food processing, outdoor marine, caustic or other applications that specify corrosion resistant motors and continuous duty operation.

**Suitable for inverter use @ 5:1 variable torque or 2:1 constant torque.**

**Apply anywhere high quality - reliable performance is required.**

HP	RPM	Frame	Catalog #	List Price	DE Bearing	Voltage	Rated Eff %	FL Amps	"L" mm	Ship Wt.
<b>TENV construction - round body</b>										
<b>1/4</b>	3600	56C	<b>HSENO.252925</b>	<b>\$435</b>	6205	208-230 460	70.0	0.42	10.00	27
	1800	56C	<b>HSENO.254930</b>	<b>\$461</b>			74.0	0.45		29
	1200	56C	<b>HSNEO.256935</b>	<b>\$475</b>			68.0	0.56		29
<b>1/3</b>	3600	56C	<b>HSENO.332926</b>	<b>\$450</b>	6205	208-230 460	71.0	0.54	10.00	27
	1800	56C	<b>HSENO.334931</b>	<b>\$463</b>			75.0	0.59		30
	1200	56C	<b>HSENO.336936</b>	<b>\$492</b>			70.0	0.70		31
<b>1/2</b>	3600	56C	<b>HSENO.52927</b>	<b>\$468</b>	6205	208-230 460	74.0	0.77	10.00	30
	1800	56C	<b>HSENO.54932</b>	<b>\$486</b>			77.0	0.82		32
	1200	56C	<b>HSENO.56937</b>	<b>\$510</b>			74.0	0.96		34
<b>3/4</b>	3600	56C	<b>HSENO.752928</b>	<b>\$484</b>	6205	208-230 460	75.5	1.12	10.00	30
	3600	143TC	<b>CSENO.752940</b>	<b>\$476</b>			75.5	1.12		32
	1800	56C	<b>HSENO.754933</b>	<b>\$493</b>			78.0	1.22		34
	1800	143TC	<b>CSENO.754941</b>	<b>\$478</b>			78.0	1.22		36
	1200	56HC	<b>HSENO.756938</b>	<b>\$544</b>			77.0	1.36		41
	1200	143TC	<b>CSENO.756942</b>	<b>\$561</b>			77.0	1.36		42
<b>1</b>	3600	56HC	<b>HSENO12929</b>	<b>\$510</b>	6205	208-230 460	82.5	1.35	12.00	36
	1800	56HC	<b>HSENO14934</b>	<b>\$511</b>			82.0	1.52		37
	1200	56HC	<b>HSENO16939</b>	<b>\$561</b>			80.0	1.72		44
<b>TEFC construction - round body</b>										
<b>1/4</b>	3600	56C	<b>HSNO.252410</b>	<b>\$435</b>	6205	208-230 460	70.0	0.42	12.00	29
	1800	56C	<b>HSNO.254417</b>	<b>\$461</b>			74.0	0.45		32
	1200	56C	<b>HSNO.256424</b>	<b>\$475</b>			68.0	0.56		31
<b>1/3</b>	3600	56C	<b>HSNO.332411</b>	<b>\$450</b>	6205	208-230 460	71.0	0.54	12.00	29
	1800	56C	<b>HSNO.334418</b>	<b>\$463</b>			75.0	0.59		32
	1200	56C	<b>HSNO.336425</b>	<b>\$492</b>			70.0	0.70		34
<b>1/2</b>	3600	56C	<b>HSNO.52412</b>	<b>\$468</b>	6205	208-230 460	74.0	0.77	12.00	32
	1800	56C	<b>HSNO.54419</b>	<b>\$486</b>			77.0	0.82		35
	1200	56C	<b>HSNO.56426</b>	<b>\$510</b>			74.0	0.96		37
<b>3/4</b>	3600	56HC	<b>HSNO.752413</b>	<b>\$484</b>	6205	208-230 460	75.5	1.12	12.00	32
	3600	143TC	<b>CSNO.752439</b>	<b>\$476</b>			75.5	1.12		37
	1800	56C	<b>HSNO.754420</b>	<b>\$493</b>			78.0	1.22		36
	1800	143TC	<b>CSNO.754451</b>	<b>\$478</b>			78.0	1.22		40
	1200	56HC	<b>HSNO.756427</b>	<b>\$544</b>			77.0	1.36		46
	1200	143TC	<b>CSNO.756462</b>	<b>\$561</b>			77.0	1.36		46
<b>1</b>	3600	56HC	<b>HSNO12463</b>	<b>\$510</b>	6205	208-230 460	82.5	1.35	12.00	41
	3600	143TC	<b>CSNO12428</b>	<b>\$511</b>			82.5	1.35		41
	1800	56HC	<b>HSNO14466</b>	<b>\$511</b>			82.5	1.35		41
	1800	143TC	<b>CSNO14440</b>	<b>\$510</b>			82.5	1.52		42
	1200	56HC	<b>HSNO16469</b>	<b>\$561</b>			80.0	1.72		49
	1200	143TC	<b>CSNO16452</b>	<b>\$677</b>			80.0	1.72		49



CC068A

ISO9001

RoHS  
Compliant



# Stainless Steel roundbody 3 phase motors



TEFC - rigid base - stainless steel construction - C-face bracket

**Features:** all 300 series exterior parts, 4 condensate drains, 60/50 hertz, 1.15 service factor, class F insulation, class B temperature rise, lip seals, VPI impregnated windings, **footless**.

bulletin - #243

**1/4 - 30 hp**

**Applications include:** all washdown environments, food processing, outdoor marine, pharmaceutical, caustic or other applications that specify corrosion resistant motors and continuous duty operation.

**Suitable for inverter use @ 10:1 variable torque or 5:1 constant torque.**  
**Apply anywhere high quality - reliable performance is required.**

HP	RPM	Frame	Catalog #	List Price	DE Bearing	Voltage	Rated Eff %	FL Amps	"C" Dim	Ship Wt.
1.5	3600	56HC	HSN1.52464	\$574	6205		82.5	2.03	14.00	44
	3600	143TC	CSN1.52429	\$574	6205		82.5	2.03	12.60	44
	1800	56HC	HSN1.54467	\$567	6205	208-230	84.0	2.12	14.00	47
	1800	145TC	CSN1.54441	\$567	6205	460	84.0	2.12	13.60	48
	1200	56HC	HSN1.56470	\$1,001	6205		85.5	2.58	14.00	55
	1200	182TC	CSN1.56453	\$1,126	6306		85.5	2.19	16.00	87
2	3600	56HC	HSN022465	\$673	6205		84.0	2.59	14.00	49
	3600	145TC	CSN022430	\$674	6205		84.0	2.59	13.60	52
	1800	56HC	HSN024468	\$666	6205	208-230	84.0	2.78	14.00	53
	1800	145TC	CSN024442	\$666	6205	460	84.0	2.78	13.60	54
	1200	56HC	HSN026471	\$1,114	6205		86.5	2.90	14.00	70
	1200	184TC	CSN026454	\$1,128	6306		86.5	2.89	17.00	93
3	3600	145TC	CSN032455	\$1,027	6205		85.5	3.82	13.60	64
	3600	182TC	CSN032431	\$1,039	6306	208-230	85.5	3.78	16.00	92
	1800	182TC	CSN034443	\$1,018	6306	460	87.5	4.17	16.00	109
	1200	213TC	CSN036456	\$1,445	6208		87.5	4.28	22.00	121
5	3600	184TC	CSN052432	\$1,133	6306		87.5	6.08	17.00	107
	1800	184TC	CSN054444	\$1,133	6306	208-230	87.5	6.69	17.00	110
	1200	215TC	CSN056457	\$1,581	6208	460	87.5	7.04	22.00	144
7.5	3600	213TC	CSN7.52433	\$1,472	6208		88.5	8.92	22.00	159
	1800	213TC	CSN7.54445	\$1,461	6208	208-230	89.5	9.28	22.00	165
	1200	254TC	CSN7.56458	\$3,652	6309	460	89.5	10.6	24.00	245
10	3600	215TC	CSN102434	\$1,614	6208		89.5	11.6	22.00	178
	1800	215TC	CSN104446	\$1,603	6208	208-230	89.5	12.4	22.00	206
	1200	256TC	CSN106459	\$3,831	6309	460	89.5	13.7	25.40	272
15	3600	254TC	CSN152435	\$3,743	6309		90.2	17.6	24.00	264
	1800	254TC	CSN154447	\$3,668	6309	208-230	91.0	18.6	24.00	267
	1200	254TC	CSN156460	\$4,773	6311	460	90.2	19.3	27.00	394
20	3600	256TC	CSN202436	\$3,926	6309		90.2	23.2	25.40	300
	1800	256TC	CSN204448	\$3,852	6309	208-230	91.0	24.8	25.40	321
	1200	286TC	CSN206461	\$4,954	6311	460	90.2	25.8	27.95	449
25	3600	284TC	CSN252437	\$4,682	6311	208-230	91.0	28.9	27.00	394
	1800	284TC	CSN254449	\$4,612	6311	460	92.4	29.6	27.00	415
30	3600	286TC	CSN302438	\$4,858	6311	208-230	91.0	34.5	27.95	435
	1800	286TC	CSN304450	\$4,782	6311	460	92.4	35.5	27.95	443



CC068A

ISO9001

RoHS Compliant

Suitable for horizontal or vertical mounting



# Stainless Steel JM pump 3 phase motors



TEFC - rigid base - stainless steel frame, brackets & conduit box

**Features:** all 300 series exterior parts, 4 condensate drains, 60/50 hertz, 1.15 service factor, class F insulation, class B temperature rise, lip seals, VPI impregnated windings, **foot mounted.**

bulletin - #255

**1 - 30 hp**

**Applications include:** all washdown environments, food processing, outdoor marine, pharmaceutical, caustic or other applications that specify corrosion resistant motors and continuous duty operation.

**Suitable for inverter use @ 10:1 variable torque or 5:1 constant torque.**  
**Apply anywhere high quality - reliable performance is required.**

HP	RPM	Frame	Catalog #	List Price	DE Bearing	Voltage	Rated Eff %	FL Amps	"C" Dim	Ship Wt.
1	3600	143JM	JSA012657	\$578	6206	208-230 460	75.5	1.30	11.70	58
	1800	143JM	JSA014482	\$571	6206		82.5	1.52	11.70	55
	1200	145JM	JSA016663	\$742	6206		80.0	1.75	12.20	51
1.5	3600	143JM	JSA1.52472	\$642	6206	208-230 460	82.5	2.00	11.70	60
	1800	145JM	JSA1.54483	\$633	6206		84.0	2.20	12.20	62
	1200	182JM	JSA1.56666	\$1,244	6207		85.5	2.20	15.30	86
2	3600	145JM	JSA022473	\$750	6206	208-230 460	84.0	2.70	12.20	63
	1800	145JM	JSA024484	\$741	6206		84.0	2.80	12.20	64
	1200	184JM	JSA026669	\$1,384	6207		86.5	3.00	16.00	96
3	3600	182JM	JSA032474	\$1,145	6207	208-230 460	85.5	3.80	15.30	90
	1800	182JM	JSA034485	\$1,122	6207		87.5	4.10	15.30	94
	1200	213JM	JSA036671	\$1,591	6209		87.5	4.20	19.00	125
5	3600	184JM	JSA052475	\$1,249	6207	208-230 460	87.5	6.10	19.00	108
	1800	184JM	JSA054486	\$1,249	6207		87.5	6.50	19.00	101
	1200	215JM	JSA056675	\$1,739	6209		87.5	7.10	22.50	143
7.5	3600	213JM	JSA7.52476	\$1,620	6209	208-230 460	88.5	8.90	19.00	173
	1800	213JM	JSA7.54487	\$1,606	6209		89.5	9.40	19.00	162
	1200	254JM	JSA7.56665	\$4,031	6309		89.5	10.60	23.40	245
10	3600	215JM	JSA102477	\$1,777	6209	208-230 460	89.5	11.6	22.50	175
	1800	215JM	JSA104488	\$1,756	6209		89.5	12.5	22.50	184
	1200	256JM	JSA106662	\$4,227	6309		89.5	13.7	25.10	280
15	3600	254JM	JSA152478	\$4,139	6309	208-230 460	90.2	17.6	23.40	290
	1800	254JM	JSA154489	\$3,058	6309		91.0	18.6	23.40	313
	1200	284JM	JSA156667	\$5,265	6310		90.2	19.3	28.00	406
20	3600	256JM	JSA202479	\$4,330	6309	208-230 460	90.2	23.2	25.10	311
	1800	256JM	JSA204490	\$4,253	6309		91.0	24.8	25.10	344
	1200	286JM	JSA206672	\$5,464	6310		90.2	25.8	29.50	403
25	3600	284JM	JSA252480	\$5,174	6310	208-230 460	91.0	28.9	28.60	436
	1800	284JM	JSA254491	\$5,096	6310		92.4	29.6	28.60	456
30	3600	286JM	JSA302481	\$5,363	6310	208-230 460	91.0	34.5	28.60	467
	1800	286JM	JSA304492	\$5,286	6310		92.4	35.5	28.60	491



CC068A

ISO9001

RoHS Compliant

Suitable for horizontal or vertical mounting

# Stainless Steel Premium Efficient 3 phase motors



TEFC - rigid base - stainless steel construction - C-face bracket

**Features:** all 300 series exterior parts, 4 condensate drains, 60/50 hertz, 1.15 service factor, class F insulation, class B temperature rise, lip seals, VPI impregnated windings, **foot mounted.**

bulletin - #242

**1 - 30 hp**

**Applications include:** all washdown environments, food processing, outdoor marine, pharmaceutical, caustic or other applications that specify corrosion resistant motors and continuous duty operation.

Suitable for inverter use @ 10:1 variable torque or 5:1 constant torque.  
Apply anywhere high quality - reliable performance is required.

HP	RPM	Frame	Catalog #	List Price	DE Bearing	Voltage	Rated Eff %	FL Amps	"C" Dim	Ship Wt.
1	3600	56HC	HSP012463	\$628	6205		77.0	1.50	13.60	48
	3600	143TC	CSP012428	\$628	6205		77.0	1.50	13.50	48
	1800	56HC	HSP014466	\$628	6205	208-230	85.5	1.43	13.60	48
	1800	143TC	CSP014440	\$628	6205	460	85.5	1.43	13.50	49
	1200	56HC	HSP016469	\$690	6205		82.5	1.60	13.60	58
	1200	145TC	CSP016452	\$832	6205		82.5	1.60	14.50	59
1.5	3600	56HC	HSP1.52464	\$706	6205		84.0	1.88	13.60	52
	3600	143TC	CSP1.52429	\$706	6205		84.0	1.88	13.50	52
	1800	56HC	HSP1.54467	\$697	6205	208-230	86.5	2.08	13.60	55
	1800	145TC	CSP1.54441	\$697	6205	460	86.5	2.08	14.50	63
	1200	56HC	HSP1.56470	\$1,230	6205		87.5	2.12	13.60	66
	1200	182TC	CSP1.56453	\$1,382	6206		87.5	2.12	16.20	99
2	3600	56HC	HSP022465	\$828	6205		85.5	2.4	13.60	59
	3600	145TC	CSP022430	\$828	6205		85.5	2.4	14.50	60
	1800	56HC	HSP024468	\$819	6205	208-230	86.5	2.7	13.60	63
	1800	145TC	CSP024442	\$819	6205	460	86.5	2.7	14.50	64
	1200	56HC	HSP026471	\$1,373	6205		88.5	2.8	13.60	83
	1200	184TC	CSP026454	\$1,384	6206		88.5	2.8	17.10	110
3	3600	145TC	CSP032455	\$1,262	6205		86.5	3.6	14.50	76
	3600	182TC	CSP032431	\$1,275	6206	208-230	86.5	3.6	16.20	109
	1800	182TC	CSP034443	\$1,249	6206	460	89.5	3.7	16.20	112
	1200	213TC	CSP036456	\$1,768	6208		89.5	4.0	18.00	144
	5	3600	184TC	CSP052740	\$1,391	6206		88.5	5.9	17.10
1800		184TC	CSP054444	\$1,391	6206	208-230	89.5	6.1	17.10	121
1200		215TC	CSP056457	\$1,932	6208	460	89.5	6.4	20.00	164
7.5	3600	213TC	CSP7.52433	\$1,798	6208		89.5	8.6	18.00	174
	1800	213TC	CSP7.54445	\$1,785	6208	208-230	91.7	8.9	18.00	186
	1200	254TC	CSP7.56458	\$4,478	6309	460	91.0	9.7	23.45	282
10	3600	215TC	CSP102742	\$1,971	6208		90.2	11.2	20.00	193
	1800	215TC	CSP104758	\$1,957	6208	208-230	91.7	11.8	20.00	225
	1200	256TC	CSP106459	\$4,697	6309	460	91.0	12.9	25.20	322
15	3600	254TC	CSP152743	\$4,590	6309		91.0	16.6	23.45	307
	1800	254TC	CSP154447	\$4,492	6309	208-230	92.4	17.1	23.45	315
	1200	284TC	CSP156460	\$5,850	6311	460	91.7	18.4	26.60	467
20	3600	256TC	CSP202436	\$4,812	6309		91.0	22.1	25.20	355
	1800	256TC	CSP204448	\$4,721	6309	208-230	93.0	22.6	25.20	381
	1200	286TC	CSP206461	\$6,069	6311	460	91.7	24.4	28.10	532
25	3600	284TSC	CSP252437	\$5,737	6311		91.7	27.4	25.20	467
	1800	284TC	CSP254449	\$5,650	6311	208-230	93.6	28.0	26.60	492
30	3600	286TSC	CSP302438	\$5,952	6311		91.7	32.9	26.70	515
	1800	286TC	CSP304450	\$5,859	6311	208-230	93.6	33.4	28.10	526



CC068A

ISO9001

RoHS Compliant

# Stainless Steel Premium Efficient 3 phase motors



TEFC - rigid base - stainless steel construction - C-face bracket

**Features:** all 300 series exterior parts, 4 condensate drains, 60/50 hertz, 1.15 service factor, class F insulation, class B temperature rise, lip seals, VPI impregnated windings, **foot mounted.**

bulletin - #254

## JM 1 - 30 hp

**Applications include:** all washdown environments, food processing, outdoor marine, pharmaceutical, caustic or other applications that specify corrosion resistant motors and continuous duty operation.

Suitable for inverter use @ 10:1 variable torque or 5:1 constant torque.  
Apply anywhere high quality - reliable performance is required.

HP	RPM	Frame	Catalog #	List Price	DE Bearing	Voltage	Rated Eff %	FL Amps	"C" Dim	Ship Wt.
1	3600	143TC	JSP012100	\$651	6205	208-230 460	77.0	1.50	15.50	73
	1800	143TC	JSP014105	\$650	6205		82.5	1.43	15.50	69
	1200	145TC	JSP016110	\$852	6205		82.5	1.60	16.50	64
1.5	3600	143TC	JSP1.52115	\$730	6205	208-230 460	84.0	1.88	15.50	75
	1800	145TC	JSP1.54608	\$720	6205		86.5	2.08	16.50	77
	1200	182TC	JSP1.56610	\$1,407	6207		87.5	2.12	17.70	92
2	3600	145TC	JSP022614	\$854	6205	208-230 460	85.5	2.4	16.50	80
	1800	145TC	JSP024616	\$843	6205		86.5	2.7	16.50	81
	1200	184TC	JSP026111	\$1,417	6207		88.5	2.8	18.60	121
3	3600	182TC	JSP032101	\$1,303	6206	208-230 460	86.5	3.6	17.70	113
	1800	182TC	JSP034106	\$1,277	6206		89.5	3.7	17.70	118
	1200	213TC	JSP036617	\$1,810	6209		89.5	4.0	18.88	157
5	3600	184TC	JSP052116	\$1,418	6206	208-230 460	88.5	5.9	18.60	121
	1800	184TC	JSP054609	\$1,422	6206		89.5	6.1	18.60	127
	1200	215TC	JSP056112	\$1,978	6208		89.5	6.4	20.88	179
7.5	3600	213TC	JSP7.52102	\$1,853	6208	208-230 460	89.5	8.6	18.88	217
	1800	213TC	JSP7.54107	\$1,829	6208		91.7	8.9	18.88	203
	1200	254TC	JSP7.56612	\$4,581	6309		91.0	9.7	24.70	307
10	3600	215TC	JSP102615	\$2,023	6208	208-230 460	90.2	11.2	20.88	220
	1800	215TC	JSP104611	\$1,999	6208		91.7	11.8	20.88	231
	1200	256TC	JSP106113	\$4,805	6309		91.0	12.9	26.45	352
15	3600	254TC	JSP152103	\$4,708	6309	208-230 460	91.0	16.6	24.70	364
	1800	254TC	JSP154108	\$4,617	6309		92.4	17.1	24.70	393
	1200	284TC	JSP156613	\$5,987	6311		91.7	18.4	27.23	510
20	3600	256TC	JSP202117	\$4,925	6309	208-230 460	91.0	22.1	26.45	930
	1800	256TC	JSP204610	\$4,835	6309		93.0	22.6	26.45	431
	1200	286TC	JSP206114	\$6,213	6311		91.7	24.4	28.73	581
25	3600	284TC	JSP252104	\$5,888	6311	208-230 460	91.7	27.4	27.23	547
	1800	284TC	JSP254618	\$5,798	6311		93.6	28.0	27.23	572
30	3600	286TC	JSP302607	\$6,103	6311	208-230 460	91.7	32.9	28.73	586
	1800	286TC	JSP304109	\$6,015	6311		93.6	33.4	28.73	616



CC068A

ISO9001

RoHS Compliant

Suitable for horizontal or vertical mounting

# Metric B35 & B34 3 phase motors



TEFC - aluminum frame, brackets & conduit box - removable feet

**Features:** IE1 efficient 50 hertz rated @ 1.0 service factor, (capable of operating at 230/460 volts - 60 hz @ 1.15 service factor), class F insulation, class B temperature rise, VPI impregnated windings, IP54 enclosure, F3 conduit box location.

bulletin - #245

**0.18 - 1.1 kW**

**Applications include:** pumps, fans, blowers, HVAC equipment, conveyors, compressors or any applications that require metric features and B5 or B14 mounting dimensions with or without feet.

Suitable for inverter use @ 5:1 variable torque or 2:1 constant torque.  
Apply anywhere high quality - reliable performance is required.

FL Amps @ 380/460 volts

HP	RPM	Frame	Catalog #	List Price	DE Bearing	Voltage	Rated Eff %	FL Amps	"L" mm	Ship Wt.
<b>B35 (B5 flange - with mounting feet)</b>										
<b>0.18kW 1/4 hp</b>	3000	63	<b>F0.182141</b>	<b>\$149</b>	6201	190/380 230/460	65.0	0.53/0.43	230	11
	1500	63	<b>F0.184142</b>	<b>\$158</b>	6201		60.0	0.62/0.51	230	11
	1000	71	<b>F0.186143</b>	<b>\$195</b>	6202		56.0	0.74/0.60	255	16
<b>0.25kW 1/3 hp</b>	3000	63	<b>F0.252150</b>	<b>\$149</b>	6201	190/380 230/460	68.0	0.69/0.56	230	11
	1500	71	<b>F0.254151</b>	<b>\$188</b>	6202		65.0	0.79/0.63	255	15
	1000	71	<b>F0.256135</b>	<b>\$210</b>	6202		59.0	0.95/0.77	255	16
<b>0.37kW 1/2 hp</b>	3000	71	<b>F0.372133</b>	<b>\$181</b>	6202	190/380 230/460	70.0	0.99/0.80	255	15
	1500	71	<b>F0.374134</b>	<b>\$201</b>	6202		67.0	1.12/0.88	255	16
	1000	80M	<b>F0.376144</b>	<b>\$226</b>	6204		62.0	1.30/1.05	295	24
<b>0.55kW 3/4 hp</b>	3000	71	<b>F0.552208</b>	<b>\$183</b>	6202	190/380 230/460	73.0	1.40/1.12	255	16
	1500	80M	<b>F0.554139</b>	<b>\$222</b>	6204		71.0	1.60/1.24	295	23
	1000	80M	<b>F0.556146</b>	<b>\$243</b>	6204		65.0	1.80/1.45	295	28
<b>0.75kW 1 hp</b>	3000	80M	<b>F0.752131</b>	<b>\$227</b>	6204	190/380 230/460	75.0	1.80/1.47	295	26
	1500	80M	<b>F0.754140</b>	<b>\$236</b>	6204		73.0	2.00/1.62	295	24
<b>1.1kW 1 1/2 hp</b>	3000	80M	<b>F1.12132</b>	<b>\$224</b>	6204	190/380 230/460	77.0	2.60/2.08	295	29
<b>B34 (B14 face - with mounting feet)</b>										
<b>0.18kW 1/4 hp</b>	3000	63	<b>R0.182141</b>	<b>\$149</b>	6201	190/380 230/460	65.0	0.53/0.43	230	11
	1500	63	<b>R0.184142</b>	<b>\$158</b>	6201		60.0	0.62/0.51	230	11
	1000	71	<b>R0.186143</b>	<b>\$195</b>	6202		56.0	0.74/0.60	255	16
<b>0.25kW 1/3 hp</b>	3000	63	<b>R0.252150</b>	<b>\$149</b>	6201	190/380 230/460	68.0	0.69/0.56	230	11
	1500	71	<b>R0.254151</b>	<b>\$188</b>	6202		63.0	0.79/0.63	255	15
	1000	71	<b>R0.256135</b>	<b>\$210</b>	6202		59.0	0.95/0.77	255	16
<b>0.37kW 1/2 hp</b>	3000	71	<b>R0.372133</b>	<b>\$181</b>	6202	190/380 230/460	70.0	0.99/0.80	255	15
	1500	71	<b>R0.374134</b>	<b>\$201</b>	6202		67.0	1.12/0.88	255	16
	1000	80M	<b>R0.376144</b>	<b>\$226</b>	6204		62.0	1.30/1.05	295	24
<b>0.55kW 3/4 hp</b>	3000	71	<b>R0.552208</b>	<b>\$183</b>	6202	190/380 230/460	73.0	1.40/1.12	255	16
	1500	80M	<b>R0.554139</b>	<b>\$222</b>	6204		71.0	1.60/1.24	295	23
	1000	80M	<b>R0.556146</b>	<b>\$243</b>	6204		65.0	1.80/1.45	295	28
<b>0.75 kW 1 hp</b>	3000	80M	<b>R0.752131</b>	<b>\$227</b>	6204	190/380 230/460	75.0	1.80/1.47	295	26
	1500	80M	<b>R0.754140</b>	<b>\$236</b>	6204		73.0	2.00/1.62	295	24
<b>1.1kW 1 1/2 hp</b>	3000	80M	<b>R1.12132</b>	<b>\$244</b>	6204	190/380 230/460	77.0	2.60/2.08	295	29



ISO9001

RoHS Compliant

Suitable for horizontal or vertical mounting

# Metric B3 Premium Efficient 3 phase motors



TEFC - aluminum frame & conduit box - cast iron brackets - removable feet

**Features:** IE3 efficient 50 hertz rated @ 1.0 service factor, (capable of operating at 230/460 volts - 60 hz @ 1.15 service factor), class F insulation, class B temperature rise, VPI impregnated windings, IP54 enclosure, F3 conduit box location.

bulletin - #210

**0.75 - 18.5 kW**

**Applications include:** pumps, fans, blowers, HVAC equipment, conveyors, compressors or any applications that require metric features and mounting dimensions with or without feet.

**Suitable for inverter use @ 5:1 variable torque or 2:1 constant torque. Apply anywhere high quality - reliable performance is required.**

FL Amps @ 380/460 volts

HP	RPM	Frame	Catalog #	List Price	DE Bearing	Voltage	Rated Eff %	FL Amps	"L" mm	Ship Wt.
0.75kW 1 hp	1000	90S	MP0.756175	\$529	6205	190/380 230/460	78.9/82.5	2.00/1.60	360	33
1.1kW 1.5 hp	1500	90S	MP1.14167	\$524	6205	190/380	84.1/86.5	2.60/2.10	360	36
	1000	90L	MP1.16176	\$609	6205	230/460	81.0/87.5	2.80/2.10	390	44
1.5kW 2 hp	3000	90S	MP1.52159	\$535	6205	190/380	84.2/85.5	3.20/2.60	360	48
	1500	90L	MP1.54168	\$573	6205	230/460	85.3/86.5	3.50/2.80	390	41
	1000	100L	MP1.56177	\$733	6206		82.5/88.5	3.80/2.90	435	47
2.2kW 3 hp	3000	90L	MP2.22160	\$590	6205	190/380	85.9/86.5	4.60/3.70	390	54
	1500	100L	MP2.24169	744	6206	230/460	86.7/89.5	4.80/3.80	435	58
	1000	112M	MP2.26178	\$931	6206		84.3/89.5	5.40/4.10	470	71
3.0kW 4 hp	3000	100L	MP3.02161	\$792	6206	190/380	87.1/87.9	6.00/5.00	435	60
	1500	100L	MP3.04170	\$819	6206	230/460	87.8/89.5	6.30/5.10	435	68
		132S	MP3.06179	\$1,304	6208		85.6/89.5	7.30/5.60	510	121
4kW 5.5 hp	3000	112M	MP4.02162	\$988	6206	190/380	88.1/88.9	7.80/6.40	470	94
	1500	112M	MP4.04171	\$1,017	6206	230/460	88.6/89.5	8.40/6.80	470	78
	1000	132M	MP4.06180	\$1,519	6208		86.8/89.5	9.50/7.50	560	159
5.5kW 7.5 hp	3000	132S	MP5.52163	\$1,400	6208	190/380	89.2/89.9	10.6/8.70	510	128
	1500	132S	MP5.54172	\$1,410	6208	230/460	89.6/91.7	11.2/9.00	510	121
	1000	132M	MP5.56181	\$1,651	6208		88.0/91.0	12.7/10.0	560	178
7.5kW 10 hp	3000	132S	MP7.52164	\$1,559	6208	190/380	90.1/91.0	14.4/11.7	510	153
	1500	132M	MP7.54173	\$1,619	6208	230/460	90.4/91.7	15.0/12.1	560	159
	1000	160M	MP7.56182	\$2,404	6309		89.1/91.0	16.2/12.9	670	239
11kW 15 hp	3000	160M	MP112189	\$2,567	6309	190/380	91.2/92.4	20.6/16.9	670	252
	1500	160M	MP114848	\$2,525	6309	230/460	91.4/92.4	21.5/17.4	670	247
	1000	160L	MP116846	\$2,903	6309		90.3/91.7	23.1/18.6	700	284
15kW 20 hp	3000	160M	MP152847	\$2,776	6309	190/380	91.9/92.4	27.9/23.0	670	275
	1500	160L	MP154852	\$2,892	6309	230/460	91.2/93.0	28.8/23.3	700	286
18.5 kW 25 hp	3000	160L	MP18.2207	\$3,058	6309	190/380 230/460	92.4/92.9	32.4/28.2	700	302



ISO9001

RoHS  
Compliant

Suitable for horizontal or vertical mounting

# Metric B35 Premium Efficient 3 phase motors



TEFC - aluminum frame & conduit box - cast iron brackets - removable feet

**Features:** IE3 efficient 50 hertz rated @ 1.0 service factor, (capable of operating at 230/460 volts - 60 hz @ 1.15 service factor), class F insulation, class B temperature rise, VPI impregnated windings, IP54 enclosure, F3 conduit box location.

bulletin - #212

**0.75 - 18.5 kW**

**Applications include:** pumps, fans, blowers, HVAC equipment, conveyors, compressors or any applications that require metric features and B5 flange mounting dimensions with or without feet.

**Suitable for inverter use @ 5:1 variable torque or 2:1 constant torque. Apply anywhere high quality - reliable performance is required.**

FL Amps @ 380/460 volts

HP	RPM	Frame	Catalog #	List Price	DE Bearing	Voltage	Rated Eff %	FL Amps	"L" mm	Ship Wt.
0.75kW 1 hp	1000	90S	FP0.756149	\$560	6205	190/380 230/460	78.9/82.5	2.00/1.60	360	33
1.1kW 1 1/2 hp	1500	90S	FP1.14141	\$555	6205	190/380	84.1/86.5	2.60/2.10	360	36
	1000	90L	FP1.16150	\$646	6205	230/460	81.0/87.5	2.80/2.10	390	44
1.5kW 2 hp	3000	90S	FP1.52133	\$567	6205	190/380 230/460	84.2/85.5	3.20/2.60	360	48
	1500	90L	FP1.54142	\$608	6205		85.3/86.5	3.50/2.80	390	41
	1000	100L	FP1.56151	\$777	6206		82.5/88.5	3.80/2.90	435	47
2.2kW 3 hp	3000	90L	FP2.22134	\$626	6205	190/380 230/460	85.9/86.5	4.60/3.70	390	54
	1500	100L	FP2.24143	\$788	6206		86.7/89.5	4.80/3.80	435	58
	1000	112M	FP2.26152	\$986	6206		84.3/89.5	5.40/4.10	470	71
3.0kW 4 hp	3000	100L	FP3.02135	\$839	6206	190/380 230/460	87.1/87.9	6.00/5.00	435	60
	1500	100L	FP3.04144	\$868	6206		87.8/89.5	6.30/5.10	435	68
	132S	FP3.06153	\$1,381	6208	85.6/89.5		7.30/5.60	510	121	
4kW 5 1/2 hp	3000	112M	FP4.02136	\$1,047	6206	190/380 230/460	88.1/88.9	7.80/6.40	470	94
	1500	112M	FP4.04145	\$1,077	6206		88.6/89.5	8.40/6.80	470	78
	1000	132M	FP4.06154	\$1,608	6208		86.8/89.5	9.50/7.50	560	159
5.5kW 7 1/2 hp	3000	132S	FP5.52137	\$1,483	6208	190/380 230/460	89.2/89.9	10.6/8.70	510	128
	1500	132S	FP5.54146	\$1,493	6208		89.6/91.7	11.2/9.00	510	121
	1000	132M	FP5.56155	\$1,747	6208		88.0/91.0	12.7/10.0	560	178
7.5kW 10 hp	3000	132S	FP7.52138	\$1,649	6208	190/380 230/460	90.1/91.0	14.4/11.7	510	153
	1500	132M	FP7.54147	\$1,715	6208		90.4/91.7	15.0/12.1	560	159
	1000	160M	FP7.56156	\$2,544	6309		89.1/91.0	16.2/12.9	670	239
11kW 15 hp	3000	160M	FP112206	\$2,716	6309	190/380 230/460	91.2/92.4	20.6/16.9	670	252
	1500	160M	FP114198	\$2,671	6309		91.4/92.4	21.5/17.4	670	247
	1000	160L	FP116850	\$3,072	6309		90.3/91.7	23.1/18.6	700	284
15kW 20 hp	3000	160M	FP152842	\$2,938	6309	190/380 230/460	91.9/92.4	27.9/23.0	670	275
	1500	160L	FP154844	\$3,061	6309		91.2/93.0	28.8/23.3	700	286
18.5 kW 25 hp	3000	160L	FP18.52190	\$3,236	6309	190/380 230/460	92.4/92.9	32.4/28.2	700	302



ISO9001

RoHS Compliant

Suitable for horizontal or vertical mounting



# Metric B3 Premium Efficient 3 phase motors



TEFC - cast iron frame, brackets & conduit box

**Features:** IE3 efficient 50 hertz rated @ 1.0 service factor, (capable of operating at 230/460 volts - 60 hz @ 1.15 service factor), class F insulation, class B temperature rise, VPI impregnated windings, IP54 enclosure, F3 conduit box location.

bulletin - #213

**20 - 90 kW**

**Applications include:** pumps, fans, blowers, HVAC equipment, conveyors, compressors or any applications that require metric features and mounting dimensions.

**Suitable for inverter use @ 20:1 variable torque or 10:1 constant torque. Apply anywhere high quality - reliable performance is required.**

FL Amps @ 380/460 volts

HP	RPM	Frame	Catalog #	List Price	DE Bearing	Voltage	Rated Eff %	FL Amps	"L" mm	Ship Wt.
15kW 20 hp	1000	180M	MMP156556	\$3,545	6311	190/380 230/460	91.2/92.7	30.9/25.1	29.13	480
18.5kW 25 hp	1500	180M	MMP18.54538	\$3,447	6311	190/380	92.6/93.6	35.3/28.5	29.13	449
	1000	200L	MMP18.56557	\$3,205	6312	230/460	91.7/93.0	37.8/30.5	31.10	583
22kW 30 hp	3000	180M	MMP222547	\$3,581	6311	190/380 230/460	92.7/93.7	40.5/33.5	29.13	444
	1500	180L	MMP224539	\$3,727	6311		93.0/93.9	41.8/33.9	31.10	469
	1000	200L	MMP226558	\$4,594	6312		92.2/93.2	44.8/36.3	31.10	621
30kW 40 hp	3000	200L	MMP302548	\$4,889	6312	380 460	93.3/93.9	54.9/45.3	31.10	596
	1500	200L	MMP304540	\$5,001	6312		93.6/94.6	56.6/46.0	31.10	646
	1000	225M	MMP306560	\$6,195	6313		92.9/94.1	59.1/47.7	33.66	794
37kW 50 hp	3000	200L	MMP372550	\$5,255	6312	380 460	93.7/94.2	67.4/55.5	31.10	659
	1500	225S	MMP374541	\$6,159	6313		93.9/94.5	69.6/56.6	32.68	766
	1000	250M	MMP376559	\$7,578	6314		93.3/94.6	71.7/58.1	33.66	989
45kW 60 hp	3000	225M	MMP452549	\$6,550	6313	380 460	94.0/94.7	80.8/66.4	32.48	781
	1500	225M	MMP454542	\$6,600	6313		94.2/95.0	84.8/68.4	33.66	844
	1000	280S	MMP456561	\$9,425	6314		93.7/94.5	85.8/69.6	38.78	1263
55kW 75 hp	3000	250M	MMP552551	\$8,080	6313	380 460	94.3/95.0	98.5/81.1	36.02	976
	1500	250M	MMP554543	\$8,333	6314		94.6/95.4	103/83.3	36.02	1040
	1000	280M	MMP556562	\$10,255	6317		94.1/94.5	103/84.1	40.75	1433
75kW 100 hp	3000	280S	MMP752552	\$10,663	6314	380 460	94.7/95.0	134/110	38.78	1255
	1500	280S	MMP754544	\$10,789	6317		95.0/95.4	136/111	38.78	1286
90kW 125 hp	3000	280M	MMP902553	\$11,617	6314	380 460	95.0/95.3	160/131	40.75	1372
	1500	280M	MMP904545	\$11,899	6317		95.2/95.5	163/133	40.75	1450



ISO9001

RoHS Compliant

Suitable for horizontal or vertical mounting

# Metric B35 Premium Efficient 3 phase motors



TEFC - cast iron frame, brackets & conduit box

**Features:** IE3 efficient 50 hertz rated @ 1.0 service factor, (capable of operating at 230/460 volts - 60 hz @ 1.15 service factor), class F insulation, class B temperature rise, VPI impregnated windings, IP54 enclosure, F3 conduit box location.

bulletin - #215

**20 - 90 kW**

**Applications include:** pumps, fans, blowers, HVAC equipment, conveyors, compressors or any applications that require metric features and mounting dimensions.

**Suitable for inverter use @ 20:1 variable torque or 10:1 constant torque. Apply anywhere high quality - reliable performance is required.**

FL Amps @ 380/460 volts

HP	RPM	Frame	Catalog #	List Price	DE Bearing	Voltage	Rated Eff %	FL Amps	"L" mm	Ship Wt.
15kW 20 hp	1000	180M	FFP156865	\$3,747	6311	190/380 230/460	91.2/92.7	30.9/25.1	29.13	480
18.5kW 25 hp	1500	180M	FFP18.54871	\$3,447	6311	190/380	92.6/93.6	35.3/28.5	29.13	449
	1000	200L	FFP18.56877	\$4,205	6312	230/460	91.7/93.0	37.8/30.5	31.10	583
22kW 30 hp	3000	180M	FFP222866	\$3,581	6311	190/380 230/460	92.7/93.7	40.5/33.5	29.13	444
	1500	180L	FFP224872	\$3,727	6311		93.0/93.9	41.8/33.9	31.10	469
	1000	200L	FFP226878	\$4,594	6312		92.2/93.2	44.8/36.3	31.10	621
30kW 40 hp	3000	200L	FFP302867	\$4,889	6312	380 460	93.3/93.9	54.9/45.3	31.10	596
	1500	200L	FFP304873	\$5,001	6312		93.6/94.6	56.6/46.0	31.10	646
	1000	225M	FFP306879	\$6,195	6312		92.9/94.1	59.1/47.7	33.66	794
37kW 50 hp	3000	200L	FFP372868	\$5,255	6312	380 460	93.7/94.2	67.4/55.5	31.10	659
	1500	225S	FFP374874	\$6,159	6313		93.9/94.5	69.6/56.6	32.68	766
	1000	250M	FFP376880	\$7,578	6314		93.3/94.6	71.7/58.1	33.66	989
45kW 60 hp	3000	225M	FFP452869	\$6,550	6313	380 460	94.0/94.7	80.8/66.4	32.48	781
	1500	225M	FFP454875	\$6,600	6314		94.2/95.0	84.8/68.4	33.66	844
	1000	280S	FFP456881	\$9,425	6314		93.7/94.5	85.8/69.6	38.78	1263
55kW 75 hp	3000	250M	FFP552870	\$8,080	6313	380 460	94.3/95.0	98.5/81.1	36.02	976
	1500	250M	FFP554876	\$8,333	6314		94.6/95.4	103/83.3	36.02	1040
	1000	280M	FFP556882	\$10,255	6314		94.1/94.5	103/84.1	40.75	1433
75kW 100 hp	3000	280S	FFP752552	\$10,663	6314	380 460	94.7/95.0	134/110	38.78	1255
	1500	280S	FFP754544	\$10,789	6317		95.0/95.4	136/111	38.78	1286
90kW 125hp	3000	280M	FFP902553	\$11,617	6314	380 460	95.0/95.3	160/131	40.75	1372
	1500	280M	FFP904545	\$11,899	6317		95.2/95.5	163/133	40.75	1372



ISO9001

RoHS Compliant

Suitable for horizontal or vertical mounting



# Metric B5 Premium Efficient 3 phase motors



TEFC - cast iron frame, brackets & conduit box - round body (footless)

**Features:** IE3 efficient 50 hertz rated @ 1.0 service factor, (capable of operating at 230/460 volts - 60 hz @ 1.15 service factor), class F insulation, class B temperature rise, VPI impregnated windings, IP54 enclosure, F3 conduit box location.

bulletin - #214

**20 - 75 kW**

**Applications include:** pumps, fans, blowers, HVAC equipment, conveyors, compressors or any applications that require metric features and B5 flange - footless metric dimensions.

Suitable for inverter use @ 20:1 variable torque or 10:1 constant torque. Apply anywhere high quality - reliable performance is required.

FL Amps @ 380/460 volts

HP	RPM	Frame	Catalog #	List Price	DE Bearing	Voltage	Rated Eff %	FL Amps	"L" mm	Ship Wt.
15kW 20 hp	1000	180M	FFPN156865	\$3,673	6311	190/380 230/460	91.2/92.7	30.9/25.1	29.13	480
18.5kW 25 hp	1500	180M	FFPN18.54871	\$3,572	6311	190/380	92.6/93.6	35.3/28.5	29.13	449
	1000	200L	FFPN18.56877	\$4,355	6312	230/460	91.7/93.0	37.8/30.5	31.10	583
22kW 30 hp	3000	180M	FFPN222866	\$3,711	6311	190/380 230/460	92.7/93.7	40.5/33.5	29.13	444
	1500	180L	FFPN224872	\$3,860	6311		93.0/93.9	41.8/33.9	31.10	469
	1000	200L	FFPN226878	\$4,761	6312		92.2/93.2	44.8/36.3	31.10	621
30kW 40 hp	3000	200L	FFPN302867	\$5,067	6312	380 460	93.3/93.9	54.9/45.3	31.10	596
	1500	200L	FFPN304873	\$5,184	6312		93.6/94.6	56.6/46.0	31.10	646
	1000	225M	FFPN306879	\$6,417	6313		92.9/94.1	59.1/47.7	33.66	794
37kW 50 hp	3000	200L	FFPN372868	\$5,544	6312	380 460	93.7/94.2	67.4/55.5	31.10	659
	1500	225S	FFPN374874	\$6,383	6313		93.9/94.5	69.6/56.6	32.68	766
	1000	250M	FFPN376880	\$7,849	6314		93.3/94.6	71.7/58.1	33.66	989
45kW 60 hp	3000	225M	FFPN452869	\$6,788	6313	380 460	94.0/94.7	80.8/66.4	32.48	781
	1500	225M	FFPN454875	\$6,837	6313		94.2/95.0	84.8/68.4	33.66	844
	1000	280S	FFPN456881	\$9,759	6314		93.7/94.5	85.8/69.6	38.78	1263
55kW 75 hp	3000	250M	FFPN552870	\$8,368	6313	380 460	94.3/95.0	98.5/81.1	36.02	976
	1500	250M	FFPN554876	\$8,635	6314		94.6/95.4	103/83.3	36.02	1040
	1000	280M	FFPN556882	\$10,616	6317		94.1/94.5	103/84.1	40.75	1433



ISO9001

RoHS Compliant

Suitable for horizontal or vertical mounting

# NEMA T & TC Dimensional Data

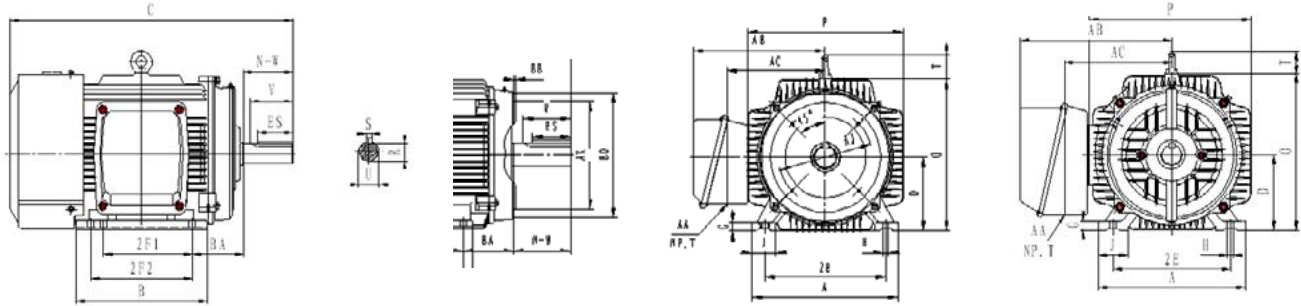

NEMA Frame	A	B	C	D	2E	2F	G	H	J	O	P	R	T	U	AA	AB	N-W	BA	Dimensions for C Face Only						
																			AH	AJ	AK	BA	BB	BD	BF
143T	7.00	6.00	13.50	3.50	5.50	4.00	0.51	0.34	1.45	7.30	7.20	0.77	xx	0.88	0.75	6.70	2.25	2.25	2.12	5.88	4.50	2.75	0.16	6.50	3/8-16
145T	7.00	6.80	14.50	3.50	5.50	5.00	0.51	0.34	1.45	7.30	7.20	0.77	xx	0.88	0.75	6.70	2.25	2.25	2.12	5.88	4.50	2.75	0.16	6.50	3/8-16
182T	9.00	7.70	16.20	4.50	7.50	4.50	0.67	0.41	1.77	9.10	9.37	0.99	1.58	1.13	0.75	7.80	2.75	2.75	2.62	7.25	8.50	3.50	0.25	9.00	1/2-13
184T	9.00	8.70	17.10	4.50	7.50	5.50	0.67	0.41	1.77	9.10	9.37	0.99	1.58	0.75	0.75	7.80	2.75	2.75	3.12	7.25	8.50	3.50	0.25	9.00	1/2-13
213T	10.5	7.50	18.00	5.30	8.50	5.50	0.79	0.41	1.97	10.9	10.9	1.20	1.97	1.38	1.00	10.0	3.38	3.50	3.12	7.25	8.50	3.50	0.25	9.00	1/2-13
215T	10.5	9.00	20.00	5.30	8.50	7.00	0.79	0.41	1.97	10.9	10.9	1.20	1.97	1.38	1.00	10.0	3.38	3.50	3.75	7.25	8.50	3.50	0.25	9.00	1/2-13
254T	12.5	10.8	23.45	6.30	10.0	8.30	0.83	0.53	2.56	13.0	13.6	1.42	2.35	1.63	1.25	11.0	4.00	4.25	3.75	7.25	10.5	4.25	0.25	9.00	1/2-13
256T	12.5	12.5	25.20	6.30	10.0	10.0	0.83	0.53	2.56	13.0	13.6	1.42	2.35	1.63	1.25	11.0	4.00	4.25	4.38	9.00	10.5	4.25	0.25	11.3	1/2-13
284T	14.0	12.5	26.60	7.00	11.0	9.50	0.94	0.53	2.76	14.6	15.1	1.59	2.35	1.88	1.50	14.2	4.62	4.75	3.00	9.00	10.5	4.75	0.25	11.3	1/2-13
284TS	14.0	12.5	26.50	7.00	11.0	9.50	0.94	0.53	2.76	14.6	15.1	1.42	2.35	1.63	1.50	14.2	3.25	4.75	4.38	9.00	10.5	4.75	0.25	11.3	1/2-13
286T	14.0	14.0	28.88	7.00	11.0	11.0	.94	0.53	2.76	14.6	15.1	1.59	2.35	1.88	1.50	14.2	4.62	4.75	3.00	9.00	10.5	4.75	0.25	11.3	1/2-13
286TS	16.0	14.0	26.70	7.00	11.0	11.0	0.94	0.53	2.76	14.6	15.1	1.42	2.35	1.63	1.50	14.2	3.25	4.75	5.00	11.0	10.5	4.75	0.25	14.0	5/8-11
324T	16.0	14.8	31.70	8.00	12.5	10.5	0.98	0.66	2.76	16.4	16.7	1.85	2.50	2.13	2.00	15.0	5.25	5.25	3.50	11.0	12.5	5.25	0.25	14.0	5/8-11
324TS	16.0	14.8	30.20	8.00	12.5	10.5	0.98	0.66	2.76	16.4	16.7	1.59	2.50	1.88	2.00	15.0	3.75	5.25	3.50	11.0	12.5	5.25	0.25	14.0	5/8-11
326T	16.0	16.3	33.30	8.00	12.5	12.0	0.98	0.66	2.76	16.4	16.7	1.85	2.50	2.13	2.00	15.0	5.25	5.25	5.25	11.0	12.5	5.25	0.25	14.0	5/8-11
326TS	16.0	16.3	31.70	8.00	12.5	12.0	0.98	0.66	2.76	16.4	16.7	1.59	2.50	1.88	2.00	15.0	3.75	5.25	5.62	11.0	12.5	5.25	0.25	14.0	5/8-11
364T	18.0	16.3	33.70	9.00	14.0	11.3	0.98	0.66	3.11	18.3	18.1	1.85	2.50	2.13	3.00	17.5	5.88	5.88	3.50	11.0	12.5	5.88	0.25	14.0	5/8-11
364TS	18.0	16.3	31.50	9.00	14.0	11.3	0.98	0.66	3.11	18.3	18.1	1.59	2.50	1.88	3.00	17.5	3.75	5.88	5.62	11.0	12.5	5.88	0.25	14.0	5/8-11
365T	18.0	18.0	37.10	9.00	14.0	12.3	0.98	0.66	3.11	18.3	18.1	2.02	2.50	2.38	3.00	17.5	5.88	5.88	3.50	11.0	12.5	5.88	0.25	14.0	5/8-11
365TS	18.0	18.0	34.65	9.00	14.0	12.3	0.98	0.66	3.11	18.3	18.1	1.59	2.50	1.88	3.00	17.5	3.75	5.88	7.00	11.0	12.5	5.88	0.25	15.5	5/8-11
404T	20.0	19.0	38.00	10.0	16.0	12.3	1.18	0.81	3.15	20.1	20.3	2.45	2.50	2.38	3.00	18.8	7.25	6.62	4.00	11.0	12.5	6.62	0.25	15.5	5/8-11
404TS	20.0	19.0	38.00	10.0	16.0	12.3	1.18	0.81	3.15	20.1	20.3	1.85	2.50	1.88	3.00	18.8	4.25	6.62	7.00	11.0	12.5	6.62	0.25	15.5	5/8-11
405T	20.0	19.0	38.00	10.0	16.0	13.8	1.18	0.81	3.15	20.1	20.3	2.45	2.50	2.88	3.00	18.8	7.25	6.62	4.00	11.0	12.5	6.62	0.25	15.5	5/8-11
405TS	20.0	19.0	38.00	10.0	16.0	13.8	1.18	0.81	3.15	20.1	20.3	1.85	2.50	2.13	3.00	18.8	4.25	6.62	8.25	16.0	12.5	6.62	0.25	18.0	5/8-11
444T	21.7	20.0	45.10	11.0	18.0	14.5	1.38	0.81	3.46	22.5	23.1	2.88	3.70	2.88	3.00	19.7	8.50	7.50	4.50	16.0	14.0	7.50	0.25	18.0	5/8-11
444TS	21.7	20.0	41.40	11.0	18.0	16.5	1.38	0.81	3.46	22.5	23.1	2.02	3.70	2.13	3.00	19.7	4.75	7.50	8.25	16.0	14.0	7.50	0.25	18.0	5/8-11
445T	21.7	20.0	45.10	11.0	18.0	16.5	1.38	0.81	3.46	22.5	23.1	2.88	3.70	2.38	3.00	19.7	8.50	7.50	4.50	16.0	14.0	7.50	0.25	18.0	5/8-11
445TS	22.0	20.0	41.40	11.0	18.0	16.5	1.38	0.81	3.46	22.5	23.1	2.02	3.70	2.38	3.00	19.7	4.75	7.50	8.25	16.0	14.0	7.50	0.25	18.0	5/8-11
447T	22.0	28.0	53.60	11.0	18.0	20.0	1.38	0.81	3.46	22.5	23.1	2.88	3.70	3.38	3.00	19.7	8.50	7.50	4.50	16.0	14.0	7.50	0.25	18.0	5/8-11
447TS	22.0	28.0	50.00	11.0	18.0	20.0	1.38	0.81	3.46	22.5	23.1	2.02	3.70	2.38	3.00	19.7	4.75	7.50	8.25	16.0	14.0	7.50	0.25	18.0	5/8-11
449T	22.0	28.0	53.60	11.0	18.0	25.0	1.38	0.81	3.46	22.5	23.1	2.88	3.70	3.38	3.00	19.7	8.50	7.50	4.50	16.0	14.0	7.50	0.25	18.0	5/8-11
449TS	22.0	28.0	50.00	11.0	18.0	25.0	1.58	0.81	3.46	22.5	23.1	2.02	3.70	2.38	3.00	19.7	4.75	7.50	11.4	16.5	14.0	7.50	0.25	18.0	5/8-11
587	28.6	29.5	65.00	14.5	23.0	25.0	1.97	1.10	5.70	33.5	28.8	3.38	4.59	3.88	3.00	27.0	11.6	10.0	9.50	16.5	14.5	10.0	0.25	18.0	5/8-11
588	28.6	41.1	79.10	14.5	23.0	25.0	1.97	1.10	5.70	33.5	28.8	3.38	4.59	3.88	3.00	27.0	11.6	10.0	11.4	16.5	14.5	10.0	0.25	18.0	5/8-11

# NEMA JM Dimensional Data

bulletin - #256

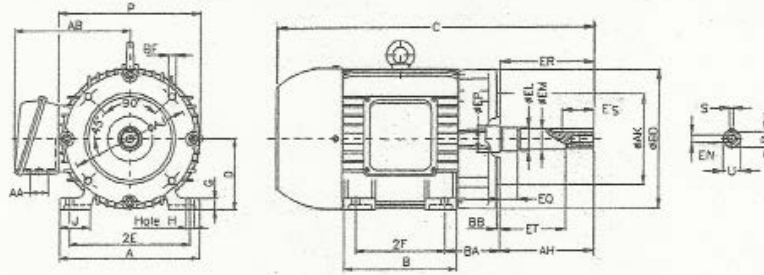

Frame	A	B	C	D	2E	2F	BA	H	G	J	O	P	AH	AB	AA
143JM	7.00	6.00	14.66	3.50	5.50	4.00	2.75	0.34	0.51	1.45	7.30	7.20	4.72	6.50	3/4
145JM	7.00	6.00	15.66	3.50	5.50	5.00	2.75	0.34	0.51	1.45	7.30	7.20	4.72	6.50	3/4
182JM	9.00	6.50	16.16	4.50	7.50	4.50	3.50	0.41	0.67	1.77	9.10	9.37	4.53	7.48	1
184JM	9.00	7.50	17.46	4.50	7.50	5.50	3.50	0.41	0.67	1.77	9.10	9.37	4.53	7.48	1
213JM	10.5	7.50	20.16	5.25	8.50	5.50	3.50	0.41	0.79	1.97	10.9	10.9	7.09	8.27	1 1/4
215JM	10.5	9.00	23.66	5.25	8.50	7.00	3.50	0.41	0.79	1.97	10.9	10.9	7.09	8.27	1 1/4
254JM	12.5	10.8	24.93	6.25	10.0	8.25	4.25	0.53	0.83	2.56	13.0	13.6	8.07	10.4	1 1/2
256JM	12.5	12.5	26.63	6.25	10.0	10.0	4.25	0.53	0.83	2.56	13.0	13.6	8.07	10.4	1 1/2
284JM	14.0	12.5	27.38	7.00	11.0	9.50	4.75	0.53	0.94	2.76	14.6	15.1	7.46	13.8	1 1/2
286JM	14.0	14.0	28.88	7.00	11.0	11.0	4.75	0.53	0.94	2.76	14.6	15.1	8.46	13.8	1 1/2
324JM	16.0	14.0	28.53	8.00	12.5	11.0	5.25	0.66	0.98	2.76	16.4	16.7	10.6	14.8	2
326JM	16.0	15.5	30.03	8.00	12.5	12.0	5.25	0.66	0.98	2.76	16.4	16.7	10.6	14.8	2
364JM	18.0	15.5	34.93	9.00	14.0	11.3	5.88	0.66	0.98	3.11	18.3	18.1	12.6	16.1	2
365JM	18.0	16.3	35.93	9.00	14.0	12.3	5.88	0.66	0.98	3.11	18.3	18.1	12.6	16.1	2
404JM	20.0	19.0	37.00	10.0	16.0	12.3	6.62	0.81	1.18	3.15	20.01	20.3	12.6	18.1	3
405JM	20.0	20.0	37.00	10.0	16.0	13.8	6.62	0.81	1.18	3.15	20.1	20.3	12.6	18.1	3

Frame	U	R	S	EN	AJ	AK	BB	BD	BF	EL	EM	EQ	ER	ES	ET
143JM	0.88	0.77	0.19	1.12	5.88	4.50	0.16	6.62	3/8-16	1.16	1.00	0.64	4.25	1.65	2.89
145JM	0.88	0.77	0.19	1.12	5.88	4.50	0.16	6.62	3/8-16	1.16	1.00	0.64	4.25	1.65	2.89
182JM	0.88	0.77	0.19	1.12	5.88	8.50	0.16	6.62	3/8-16	1.25	1.00	0.64	4.25	1.65	2.89
184JM	0.88	0.77	0.19	1.12	5.88	8.50	0.16	6.62	3/8-16	1.25	1.00	0.64	4.25	1.65	2.89
213JM	1.25	1.11	0.25	1.50	7.25	8.50	0.25	9.00	1/2-13	1.25	1.00	0.64	4.25	1.65	2.89
215JM	1.25	1.11	0.25	1.50	7.25	8.50	0.25	9.00	1/2-13	1.25	1.00	0.64	4.25	1.65	2.89
254JM	1.25	1.11	0.25	1.50	7.25	10.50	0.25	10.0	1/2-13	1.75	1.38	0.64	5.25	2.53	3.02
256JM	1.25	1.11	0.25	1.50	7.25	10.50	0.25	10.0	1/2-13	1.75	1.38	0.64	5.25	2.53	3.02
284JM	1.25	1.11	0.25	1.50	11.0	12.50	0.25	14.0	5/8-11	1.75	1.38	0.64	5.25	2.53	3.02
286JM	1.25	1.11	0.25	1.50	11.0	12.50	0.25	14.0	5/8-11	1.75	1.38	0.64	5.25	2.53	3.02
324JM	1.25	1.11	0.25	1.50	11.0	12.50	0.25	14.0	5/8-11	1.75	1.38	0.64	5.25	2.53	3.02
326JM	1.25	1.11	0.25	1.50	11.0	12.50	0.25	14.0	5/8-11	1.75	1.38	0.64	5.25	2.53	3.02
364JM	1.25	1.11	0.25	1.50	11.0	12.50	0.25	14.0	5/8-11	1.75	1.38	0.64	5.25	2.53	3.02
365JM	1.25	1.11	0.25	1.50	11.0	12.50	0.25	14.0	5/8-11	1.75	1.38	0.64	5.25	2.53	3.02
404JM	1.25	1.11	0.25	1.50	11.0	12.50	0.25	14.0	5/8-11	1.75	1.38	0.64	5.25	2.53	3.02
405JM	1.25	1.11	0.25	1.50	11.0	12.50	0.25	14.0	5/8-11	1.75	1.38	0.64	5.25	2.53	3.02

# Stainless Steel Dimensional Data

bulletin - #238

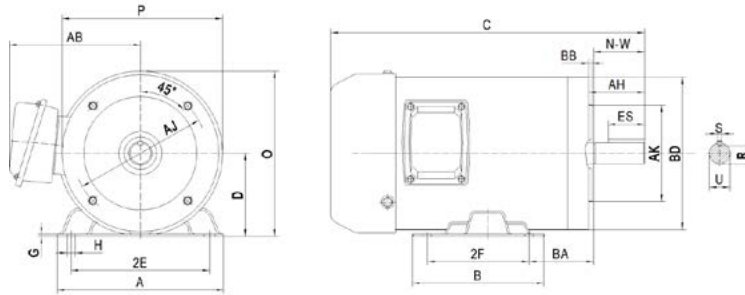

All dimensions are in inches

AA is nominal size of conduit hole

Frame	A	B	C	D	2E	2F	BA	H	O	P	U	AA	AB	N-W	AH	AJ	AK	BB	BC	BD	BF
56C	6.40	6.40	12.00	3.50	4.88	3.00	2.75	0.34	7.00	6.80	0.625	3/4	6.50	1.88	2.06	5.88	4.50	.016	-.019	6.50	3/8-16
56HC	6.40	6.40	14.00	3.50	4.88	5.00	2.75	0.34	7.00	6.80	0.625	3/4	6.50	1.88	2.12	5.88	4.50	0.16	-.019	6.50	3/8-16
143TC	6.40	6.40	12.62	3.50	5.50	4.00	2.75	0.34	7.70	6.80	0.875	3/4	6.10	2.25	2.12	5.88	4.50	0.16	0.12	6.50	3/8-16
145TC	6.40	6.40	13.62	3.50	5.50	5.00	2.75	0.34	7.70	6.80	0.875	3/4	6.10	2.25	2.12	5.88	4.50	0.16	0.12	6.50	3/8-16
182TC	6.40	6.40	16.00	4.50	7.50	4.50	2.75	0.41	9.20	8.70	1.125	3/4	7.10	2.75	2.62	7.25	8.50	0.25	0.12	9.00	1/2-13
184TC	6.40	7.40	17.00	4.50	7.50	5.50	2.75	0.41	9.20	8.70	1.125	3/4	7.10	2.75	2.62	7.25	8.50	0.25	0.12	9.00	1/2-13
213TC	10.5	8.50	20.50	5.25	8.50	5.50	3.50	0.41	10.40	10.40	1.375	1	8.27	3.38	3.12	7.25	8.50	0.25	0.25	9.00	1/2-13
215TC	10.5	8.50	22.00	5.25	8.50	7.00	3.50	0.41	10.40	10.40	1.375	1	8.27	3.38	3.12	7.25	8.50	0.25	0.25	9.00	1/2-13

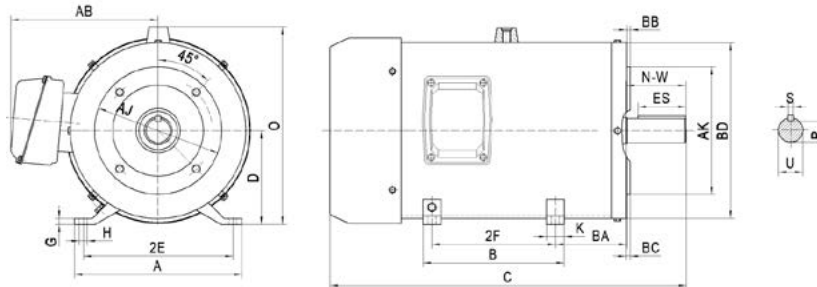

Frame	A	B	C	D	2E	2F	BA	H	O	P	U	AA	AB	N-W	AH	AJ	AK	BB	BC	BD	BF
254TC	6.40	9.4	23.75	6.25	10.0	8.25	4.25	0.53	14.20	12.50	1.625	1 1/4	9.84	4.00	3.75	7.25	8.50	0.25	0.25	9.00	1/2-13
256TC	11.2	11.2	25.38	6.25	10.0	10.00	4.25	0.53	14.20	15.50	1.625	1 1/4	9.84	4.00	3.75	7.25	8.50	0.25	0.25	10.00	1/2-13
284TC	12.2	11.1	26.56	7.00	11.0	9.50	4.75	0.53	16.60	14.00	1.875	1 1/2	11.40	4.63	4.38	9.00	10.50	0.25	0.25	11.25	1/2-13
284TSC	12.2	11.1	25.19	7.00	11.0	9.50	4.75	0.53	16.60	14.00	1.625	1 1/2	11.40	3.25	3.00	9.00	10.50	0.25	0.25	11.25	1/2-13
286TC	12.2	12.6	27.56	7.00	11.0	11.00	4.75	0.53	16.60	14.00	1.875	1 1/2	11.40	4.63	4.38	9.00	10.50	0.25	0.25	11.25	1/2-13
286TSC	12.2	12.6	26.19	7.00	11.0	11.00	4.75	0.53	16.60	14.00	1.625	1 1/2	11.40	3.25	3.00	9.00	10.50	0.25	0.25	11.25	1/2-13

Shaft Key Sizes - both "TC" & "TSC" frames use the same key as shown below

Frame	S	ES	Frame	S	ES	Frame	S	ES	Frame	S	ES
56 - 56H	0.52	1.41	143 - 145	0.19	1.41	182 - 184	0.25	1.78	213 - 215	0.31	2.41
254 - 256	0.38	2.91	284 - 286	0.38	1.91	284 - 286	0.38	1.91			

# Metric Dimensional Data

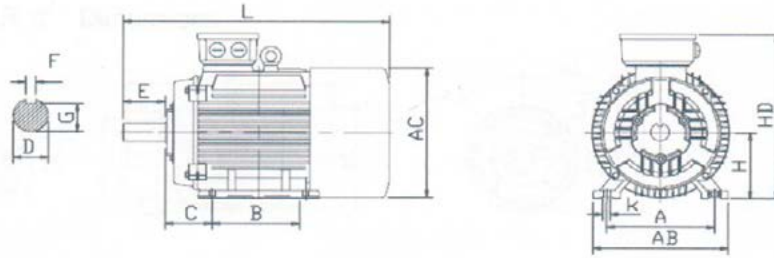

All dimensions are in millimeters

DH is thread size and depth on shaft drive end

Frame	Mounting						Shaft						General				B5 Flange					B14 Face				
	A	B	C	H	AB	K	D	E	F	G	ED	DH	L	AC	AD	HD	M	N	P	S	T	M	N	P	S	T
63	110	80	40	63	135	7	11	23	4	8.5	14	M4 x 8	230	135	70	180	115	95	140	10	3	75	60	90	M5	2.5
71	112	90	45	71	150		14	30	5	11	15	M5 x 10	255	145	80	195	130	110	160		85	70	105	M6		
80M	125	100	50	80	160	10	19	40	6	15.5	25	M6 x 12	295	165	145	220	165	130	200	12	3.5	100	80	120	M8	3
90S	140		56	90	180		24	50	20	32	M8 x 16	345	180	165	255	115						95	140			
90L	125	140	63	100	200	12	28	60	8	24	40	M10 x 20	390	205	175	275	215	180	250	15	4	130	110	160	M8	3
100L	160		70	112	230		28	60		24	40	M10 x 20	450	225	190	300						130	110	160		
112M	190	140	70	112	230	12	38	80	10	33	56	M12 x 24	465	270	220	350	265	230	300	15	4	130	110	160	M8	3
132S	216	89	132	265	465								505													
132M	178	254	108	160	315	15	42	110	12	37	72	M16 x 32	610	320	260	420	300	250	350	19	5	130	110	160	M8	3
160M	210		108	160	315								610													
160L	254	254	108	160	315	15	42	110	12	37	72	M16 x 32	685	360	265	445	300	250	350	19	5	130	110	160	M8	3
180M	279	241	121	180	355								685													
180L	279	241	121	180	355	19	55	16	49	90	M20 x 40	775	400	305	505	350	300	400	19	5	130	110	160	M8	3	
200L	318	305	133	200	395							775														815
225S	356	286	149	225	435	19	55	110	16	49	90	M20 x 40	815	450	325	550	400	450	19	5	130	110	160	M8	3	
225M-2		311											55													110
225M-4,6	406	349	168	250	490	24	60	140	18	53	90	M20 x 40	920	510	380	630	500	450	550	19	5	130	110	160	M8	3
250M-2													60													
250M-4,6	457	368	190	280	545	24	65	140	18	58	90	M20 x 40	965	550	395	675	500	450	550	19	5	130	110	160	M8	3
280S-2													65													
280S-4,6	419	368	190	280	545	24	75	140	20	67.5	90	M20 x 40	1015	550	395	675	500	450	550	19	5	130	110	160	M8	3
208M-2													65													
280M-4,6	419	368	190	280	545	24	75	140	20	67.5	90	M20 x 40	1015	550	395	675	500	450	550	19	5	130	110	160	M8	3

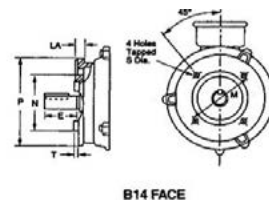
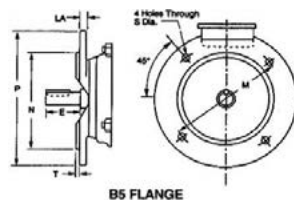

# NEMA Premium Efficient Test Data

bulletin - #235



HP	Frame	RPM	KVA Code	Current @ 460 V			Torque (lb-ft)			Efficiency %			Power Factor			Crate Size L, W, H (ins)
				Idle	FL	LR	FL	LR%	Bk%	FL	3/4	1/2	FL	3/4	1/2	
1	143T	3495	K	0.94	1.50	11	1.51	250	305	77.0	76.3	75.0	0.82	0.77	0.65	14.4x10.6x8.3
	143T	1750	K	1.04	1.50	11	3.02	275	300	85.5	85.0	83.6	0.78	0.71	0.58	14.4x10.6x8.3
	145T	1150	H	1.00	1.50	8	4.60	203	265	82.5	82.1	81.0	0.68	0.68	0.54	15.4x10.6x8.3
1.5	143T	3495	K	0.96	2.00	16	2.26	253	307	84.4	85.2	84.9	0.84	0.85	0.75	14.4x10.6x8.3
	145T	1745	J	1.46	2.10	15	4.52	268	280	86.5	86.3	85.4	0.78	0.73	0.61	15.4x10.6x8.3
	182T	1180	J	1.79	2.20	14	6.69	187	285	87.5	87.2	85.5	0.75	0.68	0.54	16.5x12.8x10.6
2	145T	3485	J	0.90	2.60	19	3.01	225	267	85.5	86.0	86.3	0.85	0.88	0.82	15.4x10.6x8.3
	145T	1740	J	1.50	2.80	19	6.04	252	280	86.5	86.8	86.2	0.78	0.75	0.64	15.4x10.6x8.3
	184T	1180	J	1.70	2.90	18	8.90	198	281	88.5	88.1	86.6	0.75	0.69	0.55	17.3x12.8x10.6
3	182T	3540	J	1.70	3.80	30	4.46	183	357	87.2	87.3	86.5	0.87	0.85	0.76	16.5x12.8x10.6
	182T	1765	J	1.80	3.70	29	8.94	217	315	89.5	89.2	88.4	0.86	0.81	0.71	16.5x12.8x10.6
	213T	1180	J	2.40	4.20	29	13.4	172	275	89.6	89.6	88.5	0.75	0.73	0.61	19.7x15.4x12.2
5	184T	3530	H	2.40	6.10	44	7.45	174	300	88.6	89.0	88.7	0.88	0.88	0.81	17.3x12.8x10.6
	184T	1755	H	3.30	6.10	42	15.0	203	255	89.5	89.2	88.7	0.86	0.82	0.73	17.3x12.8x10.6
	215T	1180	J	3.50	6.90	46	22.3	173	232	89.6	90.0	89.5	0.76	0.77	0.66	21.3x15.4x12.2
7.5	213T	3535	H	2.70	9.00	59	11.2	197	296	89.7	90.0	89.5	0.88	0.89	0.84	19.7x15.4x12.2
	213T	1770	G	3.70	9.10	56	22.3	195	264	91.7	91.5	91.1	0.85	0.83	0.74	19.7x15.4x12.2
	254T	1185	G	4.60	10.3	59	33.1	217	232	91.0	91.1	90.4	0.75	0.74	0.63	28.0x20.9x18.1
10	215T	3530	G	3.10	11.8	78	14.9	201	279	90.5	90.8	90.5	0.88	0.91	0.86	21.3x15.4x12.2
	215T	1765	F	4.50	12.1	69	29.8	183	235	91.7	91.8	91.6	0.85	0.85	0.77	21.3x15.4x12.2
	256T	1185	G	5.70	13.8	79	44.4	230	213	91.3	91.5	90.9	0.75	0.75	0.64	29.6x20.9x18.1
15	254T	3560	G	4.60	17.4	113	22.2	188	279	91.2	91.2	90.9	0.89	0.92	0.88	28.0x20.9x18.1
	254T	1775	G	5.20	17.9	111	44.4	209	263	92.4	92.3	91.8	0.85	0.87	0.81	28.0x20.9x18.1
	284T	1185	G	7.40	19.0	108	66.6	212	239	91.7	91.6	91.1	0.81	0.80	0.70	32.3x25.2x19.9
20	254T	3555	F	5.20	23.2	140	29.6	183	254	91.2	91.3	91.2	0.89	0.93	0.90	29.6x20.9x18.1
	254T	1775	G	7.00	23.7	144	59.2	213	252	93.0	92.6	92.2	0.85	0.88	0.82	29.6x20.9x18.1
	284T	1185	G	9.10	25.3	143	88.7	219	233	91.7	91.7	91.4	0.81	0.81	0.72	33.9x28.2x19.9
25	284TS	3565	F	4.80	28.4	168	36.9	167	230	91.7	92.0	91.8	0.90	0.93	0.91	30.2x25.2x19.9
	284T	1775	F	7.50	28.8	167	74.1	186	245	93.6	93.2	92.8	0.87	0.88	0.83	32.3x25.2x19.9
	324T	1185	F	11.4	30.7	169	111	210	213	93.0	93.0	92.5	0.82	0.81	0.72	34.7x26.8x21.7
30	286TS	3560	F	5.70	34.1	201	44.3	173	224	91.9	92.3	92.2	0.90	0.93	0.91	32.3x28.2x19.9
	286T	1775	F	8.80	34.5	194	88.9	183	235	93.6	93.4	93.1	0.87	0.89	0.85	33.9x28.2x19.9
	326T	1185	E	12.3	36.9	188	133	198	200	93.0	93.1	92.8	0.82	0.81	0.84	35.9x26.8x21.7
40	286TS	3570	E	10.8	45.1	244	58.9	157	268	92.4	92.1	91.6	0.90	0.91	0.87	33.1x26.8x21.7
	286T	1780	F	13.7	45.3	271	118	173	255	94.1	93.7	93.3	0.88	0.86	0.79	34.7x26.8x21.7
	326T	1190	G	15.1	46.3	285	177	197	212	94.1	94.1	93.6	0.86	0.84	0.76	36.8x30.1x24.4
50	326TS	3570	E	11.3	56.0	299	73.6	160	259	93.0	92.8	92.4	0.90	0.91	0.88	34.3x26.8x21.7
	326T	1780	F	16.4	56.3	340	148	177	252	94.5	94.0	93.7	0.88	0.87	0.81	35.9x26.8x21.7
	365T	1190	F	18.2	57.9	341	221	192	200	94.1	94.2	93.8	0.86	0.84	0.78	37.8x30.1x24.4
60	364TS	3575	F	12.5	66.7	403	88.2	168	259	93.6	93.4	93.0	0.90	0.93	0.91	33.1x30.1x24.4
	364T	1785	F	19.3	68.0	412	177	163	253	95.0	94.1	93.8	0.87	0.87	0.81	36.8x30.1x24.4
	404T	1190	F	21.6	69.2	406	265	161	225	94.5	94.4	94.1	0.86	0.85	0.78	41.2x31.9x26.0
75	365TS	3575	G	14.6	83.4	479	110	166	242	93.7	93.8	93.6	0.90	0.93	0.91	35.7x30.1x24.4
	365T	1785	F	24.3	84.7	521	221	170	251	95.4	94.5	94.1	0.87	0.88	0.82	37.8x30.1x24.4
	405T	1190	F	25.8	86.5	531	331	175	230	94.6	94.7	94.3	0.86	0.85	0.79	42.6x31.9x26.0
100	405TS	3575	F	22.4	110	667	147	143	256	94.1	94.2	94.0	0.91	0.93	0.90	39.6x31.9x26.0
	405T	1785	F	33.0	113	674	295	158	252	95.4	94.8	94.4	0.87	0.86	0.80	42.6x31.9x26.0
	444T	1190	F	36.5	115	691	442	169	236	95.0	94.8	94.3	0.86	0.83	0.76	46.7x34.3x28.4
125	444TS	3580	F	24.1	136	810	184	165	230	95.0	95.0	94.0	0.91	0.92	0.89	42.4x34.3x28.4
	444T	1790	F	32.9	140	828	367	167	242	95.4	95.0	94.7	0.88	0.90	0.85	46.9x34.3x28.4
	445T	1190	F	40.4	144	852	552	169	228	95.0	95.0	94.6	0.86	0.84	0.77	48.9x34.3x28.4
150	445TS	3580	F	35.8	163	980	220	165	225	95.0	95.1	93.8	0.91	0.92	0.89	44.1x34.3x28.4
	445T	1790	F	36.4	167	982	441	169	235	95.8	95.3	94.9	0.88	0.90	0.87	48.9x34.3x28.4
	447T	1190	F	42.5	171	1041	663	172	230	95.8	95.3	94.8	0.86	0.85	0.79	52.4x34.3x28.4
200	447TS	3580	F	36.0	214	1284	294	185	220	95.4	95.1	93.8	0.92	0.92	0.91	47.9x34.3x28.4
	447T	1790	F	42.1	222	1325	588	189	242	96.2	95.6	95.2	0.88	0.91	0.87	52.4x34.3x28.4
	449T	1190	F	50.8	228	1376	884	168	218	95.8	95.5	95.1	0.86	0.86	0.80	57.3x34.3x28.4
250	449TS	3580	E	33.5	266	1550	367	185	220	95.8	95.4	94.3	0.92	0.92	0.91	52.8x34.3x28.4
	449T	1790	F	46.6	277	1667	734	185	232	96.2	95.8	95.5	0.88	0.91	0.88	57.3x34.3x28.4

# Design D - Oil Well Pump Test Data

bulletin - #230



HP	Frame	RPM	KVA Code	FL Current @			Torque (lb-ft)			Efficiency %			Power Factor			SF	LR time hot/cold (s)
				230	460	796	FL	LR%	Bk%	FL	3/4	1/2	FL	3/4	1/2		
3	213T	1100	K	9.30	4.7	3.00	14.1	320	300	79.0	79.0	78.0	0.75	0.70	0.58	1.15	20/56
5	215T	1115	J	15.0	7.5	4.30	23.4	320	300	82.0	82.0	81.0	0.76	0.7	0.60	1.15	25/55
7.5	254T	1135	H	20.0	10.0	5.60	34.1	300	320	86.5	86.0	84.0	0.80	0.76	0.66	1.15	14/31
10	256T	1135	H	27.0	13.5	7.80	48.5	300	320	87.0	87.0	85.0	0.80	0.76	0.66	1.15	19/42
15	284T	1130	G	40.0	20	11.0	68.5	300	320	87.1	87.0	85.0	0.80	0.76	0.66	1.15	20/56
20	286T	1130	G	54.0	27	16.0	93.5	300	320	87.5	87.0	85.0	0.80	0.76	0.66	1.15	20/56
25	324T	1135	G	65.0	33	19.0	115	320	340	89.0	89.0	87.0	0.80	0.76	0.68	1.15	20/56
30	326T	1135	G	78.0	39	22.0	117	320	340	89.0	88.0	87.0	0.80	0.76	0.68	1.15	19/42
40	365T	1130	G	101	51	29.0	187	300	320	89.5	89.5	88.5	0.83	0.80	0.71	1.15	34/75
50	404T	1135	G	122	61	35.0	230	300	320	89.5	89.5	88.5	0.85	0.81	0.74	1.15	18/40
60	405T	1140	G	147	74	43.0	278	300	320	90.2	90.2	89.5	0.85	0.81	0.74	1.15	28/62
75	444T	1130	F	183	91	53.0	343	300	320	89.0	88.0	87.0	0.85	0.81	0.74	1.15	30/66
100	445T	1125	G	249	124	72.0	470	300	320	89.0	88.0	87.0	0.85	0.81	0.74	1.0	30/66
125	447T	1130	G	305	153	88.0	580	300	320	90.0	91.0	88.0	0.85	0.81	0.74	1.0	30/66
150	449T	1140	G	353	177	102	680	300	320	92.0	92.0	89.0	0.85	0.81	0.74	1.0	30/66

# Stainless Steel Test Data

bulletin - #237



Ratings 1 hp & above are NEMA Premium Efficient

HP	Frame	RPM	KVA Code	Current @ 460 V			Torque (lb-ft)			Efficiency %			Power Factor			Crate Size L, W, H (in)
				Idle	FL	LR	FL	LR%	Bk%	FL	3/4	1/2	FL	3/4	1/2	
1/4	56C	3405	J	0.22	0.42	10	0.38	230	275	70.0	71.4	69.6	0.80	0.80	0.70	13.8X10.5X8.1
	56C	1740	K	0.34	0.45	10	1.01	300	300	74.0	74.7	72.0	0.69	0.65	0.52	13.8X10.5X8.1
	56C	1140	H	0.52	0.56	10	1.16	175	265	68.0	69.7	66.1	0.62	0.55	0.43	13.8X10.5X8.1
1/3	56C	3405	J	0.32	0.54	10	0.51	230	275	71.0	73.6	71.4	0.81	0.78	0.67	13.8X10.5X8.1
	56C	1735	K	0.46	0.59	10	1.01	300	300	75.0	75.5	73.0	0.70	0.65	0.52	13.8X10.5X8.1
	56C	1140	H	0.61	0.70	10	1.55	175	265	70.0	72.4	69.7	0.62	0.56	0.44	13.8X10.5X8.1
1/2	56C	3425	K	0.41	0.77	10	0.76	230	275	74.0	74.9	74.9	0.82	0.80	0.69	13.8X10.5X8.1
	56C	1730	J	0.56	0.82	10	1.52	250	300	77.0	77.8	75.9	0.74	0.70	0.57	13.8X10.5X8.1
	56C	1135	G	0.96	0.96	10	2.32	175	265	74.0	75.9	73.5	0.66	0.59	0.46	13.8X10.5X8.1
3/4	56C	3410	H	0.59	1.12	12.5	1.15	200	275	75.5	78.1	76.9	0.83	0.82	0.71	13.8X10.5X8.1
	143TC	3410	H	0.59	1.12	12.5	1.15	200	275	75.5	78.1	76.9	0.83	0.82	0.71	14.6X10.5X8.1
	56C	1725	J	0.83	1.22	12.5	2.28	275	300	78.0	79.4	78.0	0.74	0.71	0.58	13.8X10.5X8.1
	143TC	1725	J	0.83	1.22	12.5	2.28	200	275	78.0	79.4	71.1	0.74	0.78	0.58	14.6X10.5X8.1
	56HC	1135	G	1.11	1.36	12.5	3.49	175	265	77.0	79.7	77.6	0.67	0.60	0.47	15.4X10.5X8.1
	143TC	1135	G	1.11	1.36	12.5	3.49	175	265	77.0	79.7	77.6	0.67	0.60	0.47	14.6X10.5X8.1
1	56HC	3440	J	0.63	1.35	15	1.52	185	250	82.5	81.1	79.7	0.84	0.85	0.76	15.4X10.5X8.1
	143TC	3440	J	0.63	1.50	15	1.52	185	250	82.5	81.1	79.7	0.84	0.85	0.76	14.6X10.5X8.1
	56HC	1725	H	1.06	1.52	15	3.04	250	280	82.5	82.9	81.7	0.75	0.71	0.59	15.4X10.5X8.1
	143TC	1725	K	1.04	1.50	11	3.02	275	300	85.5	85.0	83.6	0.78	0.71	0.51	14.6X10.5X8.1
	56HC	1135	G	1.50	1.72	15	4.65	170	265	80.0	80.7	78.8	0.68	0.60	0.47	15.4X10.5X8.1
	145TC	1135	H	1.00	1.70	8.0	4.60	203	265	82.5	82.1	81.0	0.68	0.68	0.54	15.4X10.5X8.1
1 1/2	56HC	3440	H	0.87	2.03	20	2.30	175	250	82.5	84.6	82.2	0.84	0.86	0.78	15.4X10.5X8.1
	143TC	3440	K	0.96	2.00	16	2.26	253	307	84.4	85.2	84.9	0.84	0.85	0.75	14.6X10.5X8.1
	56HC	1720	F	1.34	2.12	20	4.59	250	280	84.0	84.6	83.9	0.79	0.76	0.63	15.4X10.5X8.1
	145TC	1720	J	1.46	2.10	15	4.52	268	280	86.5	86.3	85.4	0.78	0.73	0.61	15.4X10.5X8.1
	56HC	1130	F	2.11	2.58	20	6.97	170	265	80.0	81.9	80.5	0.68	0.62	0.49	15.4X10.5X8.1
	182TC	1175	J	1.79	2.20	14	6.69	187	285	87.5	87.2	85.5	0.75	0.68	0.54	17.9X12.5X10.0
2	56HC	3430	H	0.91	2.59	25	3.05	170	240	84.0	84.6	84.0	0.86	0.89	0.83	15.4X10.5X8.1
	145TC	3430	J	0.91	2.60	19	3.01	225	267	85.5	86.0	86.3	0.85	0.88	0.82	15.4X10.5X8.1
	56HC	1720	J	1.64	2.78	25	4.59	235	270	84.0	85.6	85.0	0.80	0.77	0.65	15.4X10.5X8.1
	145TC	1720	J	1.50	2.80	19	6.04	262	280	86.5	86.8	86.2	0.78	0.75	0.64	15.4X10.5X8.1
	1130	J	1.70	2.90	18	8.90	198	281	88.5	88.1	86.6	0.75	0.69	0.55	18.5X12.5X10.0	
	184TC	1170	J	1.70	2.90	18	8.90	198	281	88.5	88.1	86.6	0.75	0.69	0.55	18.5X12.5X10.0
3	145TC	3510	J	1.70	3.80	30	4.46	183	357	87.2	87.3	86.5	0.87	0.85	0.76	17.3X10.5X8.1
	182TC	3510	J	1.70	3.80	30	4.46	183	357	87.2	87.3	86.5	0.87	0.85	0.76	18.1X12.5X10.0
	182TC	1765	J	1.80	3.70	29	8.94	217	315	89.2	89.2	88.4	0.86	0.81	0.71	17.9X12.5X10.0
	213TC	1170	J	2.40	4.20	29	13.4	172	275	89.6	89.6	88.5	0.75	0.73	0.61	24.4X16.5X14.6
5	184TC	3500	H	2.40	6.10	44	7.45	174	300	88.6	89.0	88.7	0.88	0.88	0.81	19.3X12.5X10.0
	184TC	1760	H	3.30	6.10	42	15.0	203	255	89.5	89.2	88.7	0.86	0.82	0.73	18.5X12.5X10.0
	215TC	1170	J	3.50	6.90	46	22.3	173	232	89.6	90.0	89.5	0.76	0.77	0.66	26.0X16.5X14.5
7 1/2	213TC	3520	H	2.70	9.00	59	11.2	197	296	89.7	90.0	89.5	0.88	0.89	0.84	24.4X16.5X14.6
	213TC	1760	G	2.70	9.10	56	22.3	195	264	91.7	91.5	91.1	0.85	0.85	0.83	24.4X16.5X14.6
	254TC	1170	G	4.60	10.3	59	33.1	217	232	91.0	91.1	90.4	0.75	0.74	0.63	28.0X20.7X18.5
10	215TC	3520	G	3.10	11.8	78	14.9	201	279	90.5	90.8	90.5	0.88	0.88	0.86	26.0X16.5X14.5
	215TC	1760	F	4.50	12.1	69	29.8	235	235	91.7	91.8	91.6	0.85	0.85	0.77	26.0X16.5X14.5
	256TC	1170	G	13.8	13.8	79	44.4	230	213	91.3	91.5	90.9	0.75	0.75	0.64	29.5X20.7X18.5
15	254TC	3560	G	4.60	17.4	113	22.2	188	279	91.2	91.2	90.9	0.89	0.92	0.88	28.0X20.7X18.5
	254TC	1765	G	5.20	17.9	111	44.4	209	263	92.4	92.3	91.8	0.85	0.87	0.81	28.0X20.7X18.5
	284TC	1175	G	7.40	19.0	108	66.6	212	239	91.7	91.6	91.1	0.81	0.80	0.70	30.9X22.6X20.1
20	256TC	3560	F	5.20	23.2	140	29.6	183	254	91.2	91.3	91.2	0.89	0.93	0.90	29.5X20.7X18.5
	256TC	1765	G	7.00	23.7	144	59.2	213	252	93.0	92.6	92.2	0.85	0.88	0.82	29.5X20.7X18.5
	286TC	1175	G	9.10	25.3	143	88.7	219	233	91.7	91.7	91.4	0.81	0.81	0.72	31.9X22.6X20.1
25	284TSC	3560	F	4.80	28.4	168	36.9	167	230	92.0	92.0	91.8	0.90	0.93	0.91	30.9X22.6X20.1
	284TC	1770	F	7.50	28.8	167	74.1	186	245	93.6	93.2	92.8	0.87	0.88	0.83	30.9X22.6X20.1
30	286TSC	3560	F	5.70	34.1	201	44.3	173	224	91.9	92.3	92.2	0.90	0.93	0.91	31.9X22.6X20.1
	286TC	1770	F	8.80	34.5	194	88.9	183	235	93.6	93.4	93.1	0.87	0.87	0.85	31.9X22.6X20.1



# Metric 50/60 Hertz Test Data

bulletin - #250



## IE2 Efficient Rated

kW HP	Frame	RPM		KVA Code 60	Current @ 380 - 460 V				Torque (lb-ft)						% FL Efficiency		Power Factor		Crate Size L, W, H (in)
		50	60		FL		LR		FL		LR%		BK%		50	60	50	60	
		50	60		50	60	50	60	50	60	50	60	50	60	50	60	50	60	
<b>.18kW</b> <b>1/4 hp</b>	63	2720	3264	K	0.53	0.43	2.90	2.60	0.63	0.55	220	194	220	259	65.0	65.4	0.80	0.81	245x205x170
	63	1310	1572	K	0.62	0.51	2.70	2.50	1.31	1.13	210	229	220	228	60.0	60.5	0.73	0.74	245x205x170
	71	850	1020	K	0.74	0.60	3.00	2.70	2.02	1.75	190	198	190	239	56.0	56.9	0.66	0.66	270x220x180
<b>.25kW</b> <b>1/3 hp</b>	63	2720	3264	K	0.69	0.56	3.80	3.40	0.88	0.72	220	194	220	257	68.0	68.4	0.81	0.82	245x205x170
	71	1330	1596	K	0.79	0.63	4.10	3.70	1.80	1.47	210	234	220	237	65.0	66.8	0.74	0.75	270x220x180
	71	850	1020	K	0.95	0.77	3.80	3.40	2.81	2.30	190	208	190	235	59.0	60.0	0.68	0.70	270x220x180
<b>.37kW</b> <b>1/2 hp</b>	71	2740	3288	K	0.99	0.80	6.00	5.40	1.29	1.08	220	216	220	259	70.0	70.8	0.81	0.82	270x220x180
	71	1330	1596	K	1.12	0.88	5.80	5.20	2.66	2.23	210	233	220	225	67.0	68.6	0.75	0.77	270x220x180
	80M	885	1062	K	1.30	1.05	6.10	5.50	3.99	3.35	190	208	190	219	62.0	63.2	0.70	0.70	315x245x195
<b>.55kW</b> <b>3/4</b>	71	2740	3288	K	1.40	1.12	8.50	7.70	1.92	1.62	230	215	230	284	73.0	74.2	0.82	0.83	270x220x180
	70M	1390	1668	K	1.60	1.24	8.30	7.50	3.78	3.20	210	223	220	292	71.0	72.5	0.75	0.77	315x245x195
	80M	885	1062	K	1.80	1.45	8.50	7.60	5.94	5.03	190	196	190	243	65.0	66.0	0.72	0.72	315x245x195
<b>5kW</b> <b>1 hp</b>	80M	2845	3414	K	1.80	1.47	11.0	9.90	2.52	2.09	230	215	230	233	75.0	76.5	0.83	0.84	315x245x195
	80M	1380	1656	K	2.00	1.62	12.0	10.8	5.19	4.30	210	223	220	265	73.0	74.4	0.76	0.78	315x245x195
<b>1.1KW</b> <b>1.5 hp</b>	80M	2845	3408	K	2.60	2.08	18.2	16.4	3.69	3.13	230	212	230	300	77.0	78.2	0.84	0.85	315x245x195

# Metric 50/60 Hertz Test Data

bulletin - #257



## IE3 Premium Efficient Rated

kW HP	Frame	RPM		KVA Code 60	Current @ 380 - 460 V				Torque (lb-ft)						% FL Efficiency		Power Factor		Crate Size L, W, H (in)
		50	60		FL		LR		FL		LR%		BK%		50	60	50	60	
		50	60		50	60	50	60	50	60	50	60	50	60	50	60	50	60	
.75kW 1 hp	90S	945	1134	H	2.00	1.60	12.0	7.90	5.59	4.70	200	176	210	252	78.9	82.5	0.71	0.72	335x265x215
1.1kW 1.5 hp	90S 90L	1430 950	1716 1140	J J	2.60 2.80	2.10 2.10	18.2 16.8	13.6 10.6	5.42 8.19	4.50 6.80	230 200	202 176	230 210	276 252	84.1 81.0	86.5 87.5	0.76 0.73	0.77 0.74	335x265x215 360x265x215
1.5kW 2 hp	90S 90L 100L	2880 1440 950	3456 1728 1140	J J H	3.20 3.50 3.80	2.60 2.80 2.90	24.3 26.6 24.7	18.2 19.0 17.2	3.67 7.38 200	3.10 6.20 9.30	220 230 200	194 202 176	230 230 210	276 276 252	84.2 85.3 82.5	85.5 86.5 88.5	0.84 0.77 0.73	0.85 0.78 0.74	335x265x215 360x265x215 405x300x255
2.2kW 3 hp	90L 100L 112M	2880 1440 965	3456 1728 1158	H J H	4.60 4.80 5.40	3.70 3.80 4.10	35.0 36.5 35.6	25.3 26.7 25.0	5.39 10.8 16.1	4.50 9.00 13.4	220 230 200	194 202 176	230 230 210	276 276 252	85.9 86.7 84.3	86.5 89.5 89.5	0.85 0.81 0.74	0.86 0.82 0.74	360x265x215 405x300x255 420x323x270
3kW 4 hp	100L 100L 132S	2880 1455 975	3456 1746 1170	H H H	6.00 6.30 7.30	5.00 5.10 5.60	46.8 49.1 49.8	34.3 34.7 35.1	7.34 14.7 21.7	6.10 12.2 18.1	220 230 190	194 202 167	230 230 210	276 276 252	87.1 87.7 85.6	87.9 89.5 89.5	0.87 0.82 0.74	0.88 0.83 0.75	405x300x255 405x300x255 490x365x325
4kW 5.5 hp	112M 112M 132M	2915 1465 975	3498 1758 1170	J J H	7.80 8.40 9.50	6.40 6.80 7.50	64.7 66.4 64.6	49.2 49.6 47.1	9.67 19.4 28.9	8.10 16.1 24.1	220 220 190	194 194 167	230 230 210	276 276 252	88.1 88.6 86.8	88.9 89.5 89.5	0.88 0.82 0.74	0.89 0.83 0.75	420x323x270 420x323x270 530x365x325
5.5kW 7.5 hp	132S 132S 132M	2935 1465 975	3522 1758 1170	J H H	10.6 11.2 12.7	8.70 9.00 10.0	88.0 84.0 88.9	66.4 62.3 64.6	13.2 26.5 39.8	11.0 22.0 33.1	200 200 190	176 176 167	230 230 210	276 276 252	89.2 89.6 88.0	89.9 91.7 91.0	0.88 0.83 0.75	0.89 0.84 0.76	490x365x325 490x365x325 530x365x325
7.5kW 10 hp	132S 132M 160M	2930 1470 980	3516 1764 1176	H H H	14.4 15.0 16.2	11.7 12.1 12.9	114 116 113	85.0 86.0 83.3	15.0 36.1 53.9	12.1 30.0 44.9	200 200 190	176 176 167	230 230 210	276 276 252	90.1 90.4 89.1	91.2 91.7 91.0	0.88 0.84 0.79	0.89 0.85 0.80	490x365x325 530x365x325 710x420x535
11kW 15 hp	160M 160M 160L	2950 1470 980	3540 1764 1176	H H H	20.6 21.5 23.1	16.9 17.4 18.6	167 168 166	125 125 119	26.3 52.8 79.0	21.9 43.9 65.9	200 200 190	176 176 167	230 230 210	276 276 252	91.2 91.4 90.3	92.0 92.4 91.7	0.89 0.85 0.80	0.90 0.86 0.81	710x420x535 710x420x535 765x420x525
15kW 20 hp	160M 160L 180M	2945 1470 980	3534 1764 1176	H H H	27.9 28.8 30.9	23.0 23.3 25.1	226 225 226	172 168 169	35.9 71.9 108	29.9 59.9 89.8	200 200 190	176 176 167	230 230 210	276 276 252	91.9 92.1 91.2	92.4 93.0 92.7	0.89 0.86 0.81	0.90 0.87 0.82	710x420x535 765x420x525 800x450x570
18.5kW 25 hp	160L 180M 200L	2945 1470 985	3534 1764 1182	H H H	32.4 35.3 37.8	28.2 28.5 30.5	266 275 276	214 203 201	44.3 88.6 132	36.9 73.8 110	200 200 190	176 176 167	230 230 210	276 276 252	92.4 92.6 91.7	92.9 93.6 93.0	0.89 0.86 0.81	0.90 0.87 0.82	765x420x525 800x450x570 870x510x625
22kW 30 hp	180M 180L 200L	2950 1475 985	3540 1770 1182	H G H	40.5 41.8 44.8	33.5 33.9 36.3	332 305 332	248 220 246	52.5 105 157	43.8 87.8 131	200 100 190	176 176 167	230 230 210	276 276 252	92.7 93.0 92.2	93.7 93.9 93.2	0.89 0.86 0.81	0.90 0.87 0.82	800x450x570 840x450x570 870x510x625
30kW 40 hp	200L 200L 225M	2965 1480 985	3558 1776 1182	H G H	54.9 56.6 59.1	45.3 46.0 47.7	417 419 408	318 314 304	71.3 143 215	59.4 119 179	200 200 190	176 176 167	230 230 210	276 276 252	93.3 93.6 92.9	93.9 94.6 94.1	0.89 0.86 0.83	0.90 0.87 0.84	870x510x625 870x510x625 935x545x690
37kW 50 hp	200L 225S 250M	2965 1480 985	3558 1776 1182	G E G	67.4 69.9 71.7	55.5 56.6 58.1	512 515 509	389 387 381	87.8 176 265	73.2 147 220	200 200 190	176 176 167	230 230 210	276 276 252	93.7 93.9 93.3	94.2 94.5 94.6	0.89 0.86 0.84	0.90 0.87 0.85	870x510x625 905x545x690 1020x605x770
45kW 60 hp	225M 225M 280S	2965 1485 990	3558 1782 1188	G G G	80.8 84.8 85.8	66.4 68.4 69.6	622 628 626	449 463 469	107 214 320	89.0 178 267	200 200 190	176 176 167	230 230 200	276 276 240	94.0 94.2 93.7	94.7 95.0 94.5	0.90 0.86 0.85	0.91 0.87 0.86	935x545x690 935x545x690 1040x650x835
55kW 75 hp	250M 250M 280M	2975 1490 990	3570 1788 1188	G F G	98.5 103 103	81.1 83.3 84.1	758 690 752	576 515 557	131 261 392	108 217 326	200 200 190	176 176 167	230 230 200	276 276 240	94.3 94.6 94.1	95.0 95.4 94.5	0.90 0.86 0.86	0.91 0.87 0.87	1020x605x770 1020x605x770 1090x650x835
75kW 100 hp	280S 280S	2975 1490	3570 1788	G G	134 136	110 111	951 938	721 707	178 355	148 295	180 200	158 176	230 230	276 276	94.7 95.0	95.0 95.4	0.90 0.88	0.91 0.89	1040x650x835 1040x650x835
90kW 125 hp	280M 280M	2975 1490	3570 1788	F F	160 163	131 133	1136 1125	859 847	213 436	177 354	180 200	158 176	230 230	276 276	95.0 95.2	95.3 95.5	0.90 0.88	0.91 0.89	1090x650x835 1090x650x835

# Accessories



bulletin - #244

T Frame Brackets			
EPAct Efficiency	Premium Efficiency	Frame	List Price
AB140	ABP140	143-145	\$22
ABF180	ABP180	182-184	\$43
AB210	ABP210	213-215	\$64
ABF250	ABP250	254-256	\$117
AB280	ABP280	284-286	\$150
AB320	ABP320	324-326	\$212
AB360	ABP360	364-365	\$266
AB400	ABP400	404-405	\$332
AB440	ABP440	444-449	\$738
AB580	N/A	587-588	N/A

C-face Brackets			
EPAct Efficiency	Premium Efficiency	Frame	List Price
CF140	CFP140	143-145	\$39
CF180	CFP180	182-184	\$66
CF210	CFP210	213-215	\$83
CF250	CFP250	254-256	\$137
CF280	CF280	284-286	\$175
CF320	CF320	324-326	\$267
CF360	CF360	364-365	\$402
CF400	CFP400	404-405	\$544
CF440	CFP440	444-449	\$686
CF580	N/A	587-588	\$1,323

D Flange Brackets			
EPAct Efficiency	Premium Efficiency	Frame	List Price
AD140	N/A	143-145	\$49
AD180	N/A	182-184	\$82
AD210	N/A	213-215	\$108
AD250	N/A	254-256	\$162
AD280	N/A	284-286	\$269
AD320	N/A	324-326	\$397
AD360	N/A	364-365	\$461
AD400	N/A	404-405	\$589
AD440	N/A	444-449	\$659
AD580	N/A	587-588	N/A

Steel Fan Covers			
EPAct Efficiency	Premium Efficiency	Frame	List Price
SF140	SFP140	143-145	\$12
SF180	SFP180	182-184	\$16
SF210	SFP210	213-215	\$19
SF250	SFP250	254-256	\$35
SF280	SFP280	284-286	\$47
SF320	SFP320	324-326	\$61
SF360	SFP360	364-365	\$83
SF400	N/A	404-405	\$103
SF440	N/A	444-449	\$250
SF580	N/A	N/A	N/A

Cast Iron Fan Covers			
EPAct Efficiency	Premium Efficiency	Frame	List Price
na	FCP400	404-405	\$490
na	FCP440	444-449	\$589
FC580	N/A	587-588	\$698

Drip Covers			
EPAct Efficiency	Premium Efficiency	Frame	List Price
DS140	DSP140	143-145	\$16
DS180	DSP180	182-184	\$21
DS210	DS0210	213-215	\$26
DS250	DSP250	254-256	\$47
DS280	DSP280	284-286	\$64
DS320	DSP320	324-326	\$83
DS360	DSP360	364-365	\$114
DS400	N/A	404-405	\$129
DS440	N/A	444-449	\$316

Cast Iron Conduit Box			
Catalog Number	Threaded Hole Size	Frame	List Price
CB150	0.75 NPT	143-145	\$24
CB210	1.0 NPT	213-215	\$47
CP250	1.25 NPT	254-256	\$47
CB280	1.5 NPT	284-286	\$69
CB320	2.0 NPT	324-326	\$76
CB370	4.0 NPT	364-449	\$136
CB580		587-588	N/A

Frame	143/5	182/4	213/5	254/6	284/6	324/6	364/5	404/5	444/9	587/8
Winding or bearing RTDs	N/A	N/A	N/A	N/A	N/A	N/A	\$600	\$600	\$600	\$600
Thermistors	\$100	\$100	\$100	\$100	\$100	\$100	\$100	\$100	\$100	\$100
Thermostats	\$50	\$150	\$150	\$150	\$150	\$150	\$150	\$150	\$150	\$150
Terminal block	\$135	\$150	\$165	\$180	\$195	\$215	\$235	\$255	\$275	\$300
Space heaters	\$130	\$165	\$165	\$250	\$250	\$250	\$250	\$280	\$280	\$500

TEFC Plastic Cooling Fans			
EPAct Efficiency	Premium Efficiency	Frame	List Price
FA140		143-145 frame except premium ratings	\$7
	FA150	143-145 frame premium ratings	\$7
	FA180	182-184 frame - standard 2 pole - all premium ratings	\$7
FA190		182-184 frame - standard 4,6,8 pole ratings	\$7
	FA210	213-215 frame - all ratings	\$10
	FA250	254-256 frame - all ratings	\$16
	FA280	284-286 frame - all ratings	\$24
	FA320	324-326 frame - all ratings	\$37
	FA360	364-365 frame - all 2 pole ratings	\$45
	FA370	364-365 frame - standard 4 pole - 4,6,8 pole premium ratings	\$45
FA380		364-365 frame - standard 6,8 pole ratings	\$45
	FA400	404-405 frame - standard 2,4 pole - all premium ratings	\$47
FA410		404-405 frame - standard 6,8 pole ratings	\$47
FA440		444-449 frame - standard 2 pole ratings	\$137
	FA400	444-449 frame - 2 pole premium ratings	\$137
FA450		444-449 frame - standard 4,6,8 pole ratings	\$137
	FA410	444-449 frame - 4,6,8 pole premium ratings	\$137
FA580		587-588 frame - all ratings	N/A

Please contact customer service for pricing of the following manufacturing options

- Roller bearing on drive end with 4140 shaft material
- Tachometer
- Encoder
- Copper bar rotor 400 frames and up
- Insulated bearing seat
- Grounding brush
- Metallic bearing isolator
- Double VPI and bake
- IP55 protection
- Any customer specific features



# *Reliable Electric Motor Company*

***principals - Quentin Ponder & W. L. "Pete" Penning***

***27427 Breakers Drive - Wesley Chapel, FL 33544***

***phone - 813.929.1874 fax - 813.929.1875***

***email - reliableelectric1@verizon.net***

***website - remcwm.com***